

Safety Information

>All electrical work must be undertaken by a qualified contractor to ensure compliance with latest edition BS 7671 and IEE/IET wiring regulations.

> Before installing an LED Street Light or doing any maintenance, ensure power supply is turned off at the circuit breaker or fuse box.

> This product is designed for permanent connection to fixed wiring; the circuit should be protected with the appropriate MCB or fuse.

Environment

> Please DO NOT dispose of electrical items or packaging as unsorted waste. Use the recycling facilities provided by your local authorities.

PRODUCT DIMENSIONS

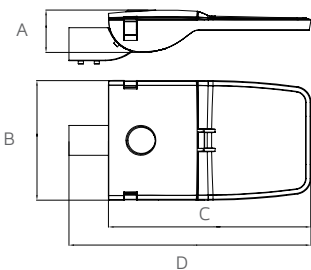

	A	B	C	D
30W	109	180	408	508
50W	109	180	408	508
100W	105	300	508	608
150W	105	300	508	608

All units are in mm

Important Warranty Information

The LED Street Light has a 3 year warranty, which can be extended free of charge to 5 years by registering online via the website address below. The registrant must provide the product part number and date of manufacture, which can be found on the label attached to the luminaire housing.

Manufactured in China by
FYT LED Co. Ltd.
NET-23-20-XX

This luminaire contains built-in LED lamps.

A++
A+
A
B
C
D
E

} LED

The lamps cannot be changed in the luminaire.

874/2012



theLIA
MEMBER



NET LED Ltd.
Buckway Business Park
300 Anderson Road
Cambridge
CB24 4UQ
sales@netled.co.uk
www.netled.co.uk

Technical Helpline: 01223
851505
Email: support@netled.co.uk

Drawing No: NET-23-20-SL-IG_V1
www.netled.co.uk/downloads

Distributed by



LED STREET LIGHT INSTALLATION GUIDE

LED STREET LIGHT NET-23-20-XX

KEY DATA

Light Source	LED			
Power	30W	50W	100W	150W
Luminous Flux	4000lm	6400lm	13600lm	20000lm
Beam Angle	140° x 70°			
Luminous Efficacy	>131lm/W	>130lm/W	>135lm/W	>130lm/W
IP Rating	IP65			
IK Rating	IK08			
Colour Temperature	4000K			
Colour Rendering	>70 CRI			
Housing Material	Aluminium			
Diffuser Material	Glass			
Manufacturer	FYT			

SUPPLY/EARTH CLASS

100-270V AC 50/60 Hz

Fig.1 Mains Input Termination



Luminaire

Mains Supply

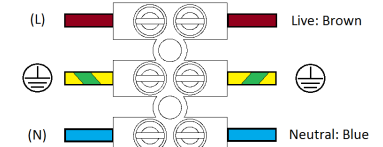

Installation procedure: Carefully read the installation instructions and ensure the mains supply is isolated before installation. Please read the safety information overleaf before carrying out any installation. Please retain this leaflet for future reference.

Street Light Installation:

Step 1: Remove the screws holding the slip-fitter, then remove the slip-fitter.

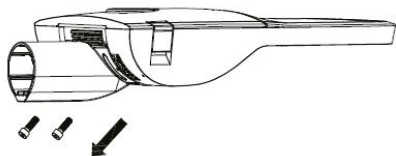

Step 2: Mount the slip fitter on the pole and secure it by tightening the two screws. Select the correct slip fitter according to the size of the pole.

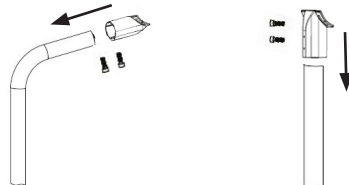

Step 3: Insert the cable into the pole and slip fitter.
Note: Cable not provided

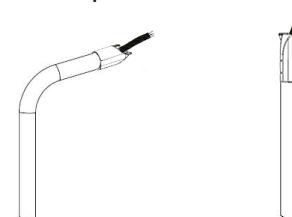

Step 4: Remove the side clips and open the cover. Feed the cable in and attach the fitting to the slip fitter.

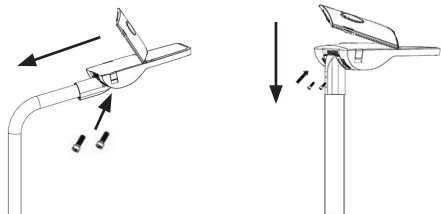

Step 5: Connect the cable to the fitting according to the wiring diagram below.

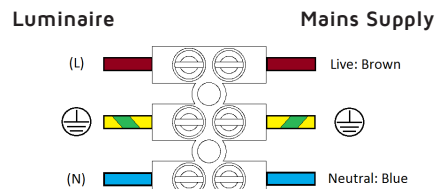

Step 6: Close the cover and fix the clips in place and alter the Street Light angle.

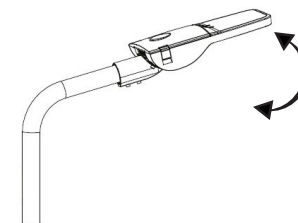

Step 7: Install black blanking cap or photocell sensor by pushing and twisting.

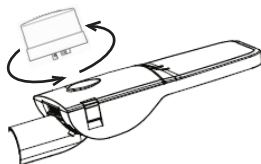

Step 8: Connect the fixture to the power line.

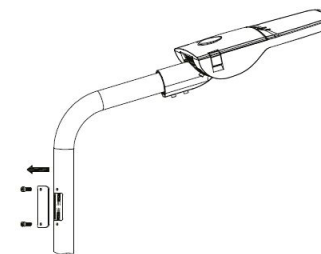

Accessories

Photocell Sensor

Add a photocell sensor to ensure the unit is switched off during daylight hours.

NET-15-20-08



Full product range available

Visit www.netled.co.uk for more commercial LED lighting products, including:

Panel Lights, Downlights, T5 and T8 Tubes, Battens, 2D Bulkheads, Gear Trays, Non-Corrosive Luminaires, High Bays and much more.