

Mains power protection

ESP M1R, M2R & M4R Series

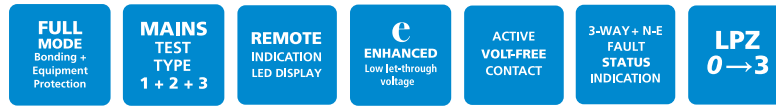

Combined Type 1, 2 and 3 tested protector (to BS EN 61643) for use on mains power distribution systems primarily to protect connected electronic equipment from transient overvoltages on the mains supply, e.g. computer, communications or control equipment. Remote display allows both display and protector unit to be mounted in their optimum positions. For use at boundaries up to LPZ 0 to protect against flashover (typically the main distribution board location, with multiple metallic services entering) through to LPZ 3 to protect sensitive electronic equipment.

Features & benefits

- The remote display means the protector can be mounted close to the incoming feed or first way on the distribution board and the display in an easily visible position, e.g. on front of cabinet
- Very low let-through voltage (enhanced protection to IEC/BS EN 62305) between all sets of conductors (phase to neutral, phase to earth, neutral to earth - Full Mode protection)
- Full Mode design capable of handling partial lightning currents as well as allowing continual operation of protected equipment
- Repeated protection in lightning intense environments
- Innovative multiple thermal disconnect technology for safe disconnection from abnormal or faulty supplies
- Remote display gives three way visual indication of protection status
- Plug-in cable connections between protector and display enable easy connection (1 m cable supplied as standard)
- Advanced pre-failure warning so you need never be unprotected
- Remote indication facility allows pre-failure warning to be linked to a building management system, buzzer or light
- Changeover active volt-free contact enables the protector to be used to warn of phase loss (i.e. power failure, blown fuses, etc)
- Unique flashing warning of potentially fatal neutral to earth supply faults (caused by incorrect earthing, wiring errors or unbalanced conditions)
- Robust steel housing (protector), and sturdy ABS housing (display)
- Base provides ultra-low inductance earth bond to metal panels
- Remote display comes with integral fixings and a panel drilling template

Application

ESP M1R: main distribution board for buildings with multiple metallic services (e.g. gas, water, telecoms) and sub-distribution boards feeding sensitive equipment. ESP M2R: main distribution board for buildings with Class III or IV LPS fitted or exposed 3-ph power lines where no LPS is fitted. ESP M4R: main distribution board for buildings with a Class I

Installation

Installation of the protector unit is identical to the ESP M1, M2 or M4. Position remote display, making sure that the cable is long enough, is unimpeded within the cabinet, and allows a minimum of 60 mm behind the panel front (for the interconnection cable). For TT installations, contact Furze.

Accessories

ESP RLA-1

Spare 1 metre cable assembly

ESP RLA-2

Spare 2 metre cable assembly

ESP RLA-4

Spare 4 metre cable assembly

Parallel connection of ESP 415 M1R to three phase star (4 wire and earth) supplies (fuses not shown for clarity)

Full product range order codes can be found on pages 17/8-17/9

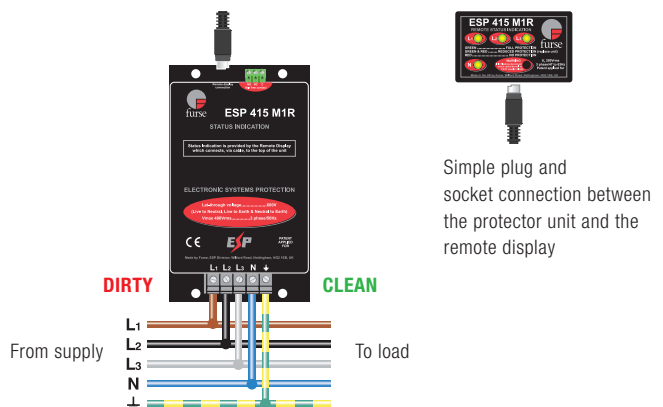

Simple plug and socket connection between the protector unit and the remote display

NOTE: For three phase applications where a remote display is unnecessary, use the respective ESP M1, M2 or M4 Series.