

Chassis locking

“Disconnected” position locking / 1 part

DB431601.ai

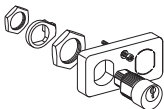

By padlocks		
	VCPO	Standard
By Profalux keylocks		
Profalux	1 lock with 1 key + adaptation kit	LV864934SP
	2 locks 1 key + adaptation kit	LV864935SP
	2 locks 2 different keys + adaptation kit	LV864936SP
1 keylock Profalux (without adaptation kit):	identical key not identified combination	LV833173SP
	identical key identified 215470 combination	LV833174SP
	identical key identified 215471 combination	LV833175SP
By Ronis keylocks		
Ronis	1 lock with 1 key + adaptation kit	LV864937SP
	2 locks 1 key + adaptation kit	LV864938SP
	2 locks 2 different keys + adaptation kit	LV864939SP
1 keylock Ronis (without adaptation kit):	identical key not identified combination	LV833189SP
	identical key identified EL24135 combination	LV833190SP
	identical key identified EL24153 combination	LV833191SP
	identical key identified EL24315 combination	LV833192SP
Adaptation kit (without keylock):	adaptation kit Profalux / Ronis	LV848564SP
	adaptation kit Kirk	LV848565SP
	adaptation kit Castell	LV848566SP

Door interlock / 1 part

DB424654.eps

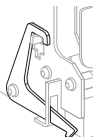

Right and left-hand side of chassis (VPECD or VPECG)	LV847914SP
--	------------

Racking interlock

DB424655.eps

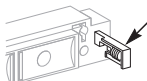

5 parts	LV864940SP
---------	------------

Breaker mismatch protection / 1 part

DB404329_2.eps



Breaker mismatch protection (VDC)	LV833767SP
-----------------------------------	------------

Chassis accessories

Auxiliary terminal shield (CB) / 1 part

DB404331_1.eps

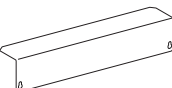

MTZ2 800/4000 A	3P	LV864942SP
	4P	LV848596SP
MTZ3 4000/6300 A	3P	LV848597SP
	4P	LV848598SP

Safety shutters + locking block / 1 part

DB404329_1.eps

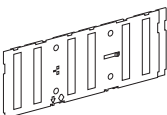

MTZ2 800/4000 A	3P	LV848721SP
	4P	LV848723SP
MTZ3 4000/6300 A	3P	LV848722SP
	4P	LV848724SP

Shutter locking block (for replacement) / 1 part

DB404333_1.eps



2 parts for 800/4000 A	LV848591SP
------------------------	------------

Front face shutter position indication and locking

DB425708.ai

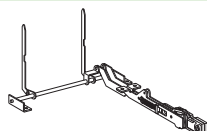

MTZ2 800/4000 A	3P	LV848592SP
MTZ3 4000/6300 A	3P	LV848593SP
	4P	LV848594SP