

Human-Machine Interface Dimensions

SDX

Compact control desks with rear panel

1 door

2 doors

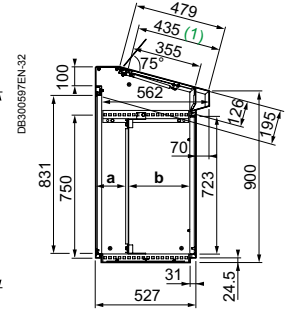
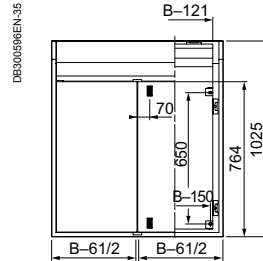
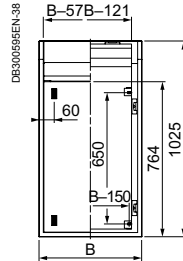

Common side view.
 (1) Useful clearance.

Cable-gland plate clearance dimensions (mm)

Width	Maximum opening
B-280	370

Adjustment of the depth of the mounting plate (mm)

Depth	Min.	Max.
a	45	395
b	126	476

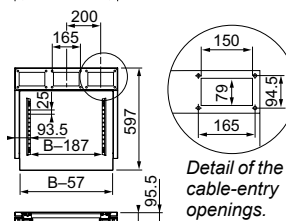

Detail of the cable-entry openings.

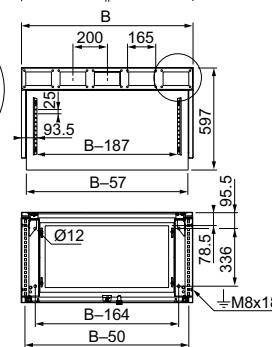
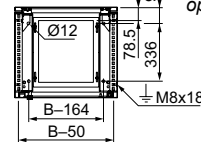

SD

Control desk with console

1 door

2 doors

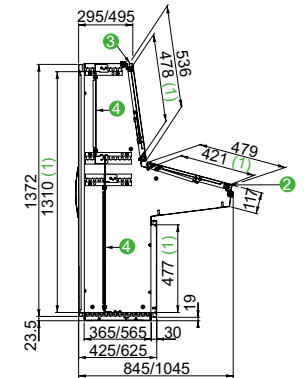
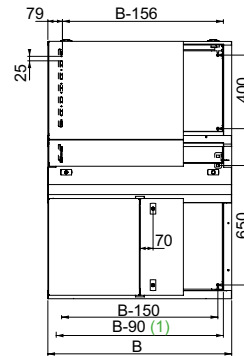
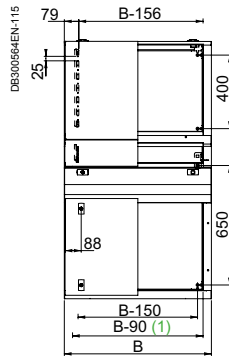

Common side view.
 (1) Useful clearance.

Cable-gland plate clearance dimensions (mm)

Width	Maximum opening
B-280	56

Notes

- 1 1 entry cable-gland plate
- 2 Maximum opening of the hinged desk lid: 75°
- 3 Maximum opening of the hinged console cover: 75°
- 4 Optional mounting plate installation, see page 468

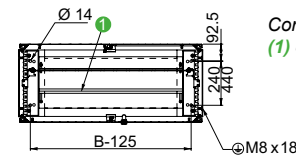
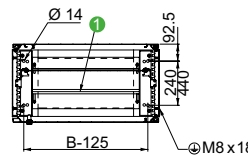

SD

SDX

Modular console

Depth 200 mm

Depth 300 mm

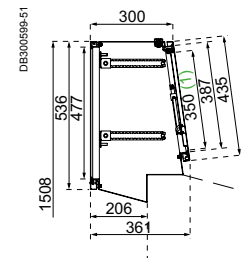
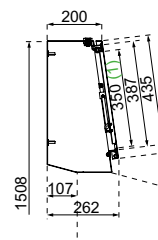
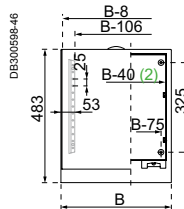

(1) Useful clearance.
 (2) Same dimensions for the rear panel.