

## secured into systems - threaded eyebolt anchors

### technical information

## drop in anchors

### technical information

#### Installation

1. Drill a hole to the minimum required depth (see opposite)
2. Blow the hole clean of dust and debris
3. Install drop in anchor using correct tool
4. Thread the eyebolt into place

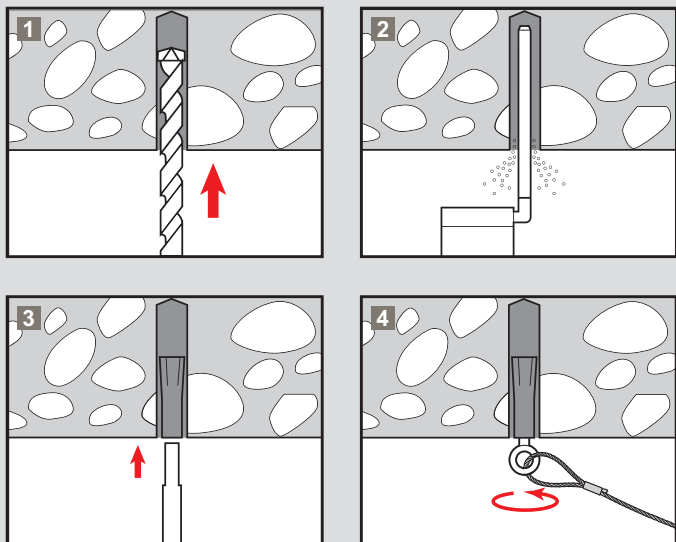

#### Installation - using the mechanism

- Pass through or around your required suspension and back through the mechanism leaving 15 cm of wire protruding
- The bolt can be used in reverse configuration and threaded into the product to be suspended
- Always confirm engagement of the mechanism on the wire by pushing the pin in the opposite direction indicated by the arrows
- To adjust, remove the load and pull the free wire slightly to disengage the mechanism then release using the adjustment pin

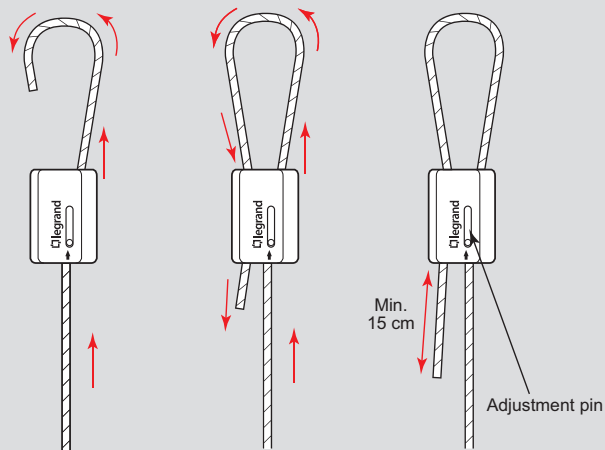

#### Drop in anchors (p. 40)

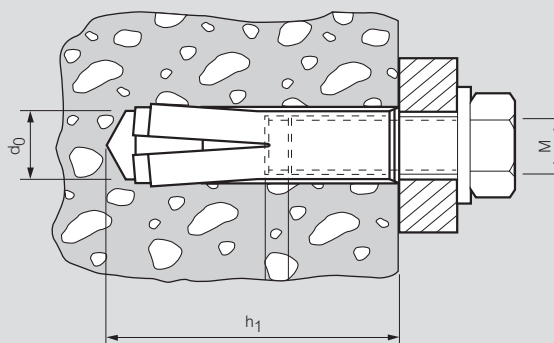

Cat. Nos.	Female thread (M)	Description	Drill dia. (d0)	Hole depth (h1)	Setting tool
SWM6DANC	M6	Drop in anchor	8 mm	25 mm approx	SWM6ST
SWM8DANC	M8	Drop in anchor	10 mm	30 mm approx	SWM8ST
SWM10DANC	M10	Drop in anchor	12 mm	40 mm approx	SWM10ST