

ARTEOR™ WITH NETATMO PRODUCT GUIDE



Contact details

United Kingdom

Great King Street North,
Birmingham, B19 2LF

Customer Services:

Tel: +44 (0) 345 605 4333

E-mail: legrand.sales@legrand.co.uk

Quotations and Technical Support:

Tel: +44 (0) 370 608 9020

E-mail: uk-uisesales@legrand.co.uk

Republic of Ireland:

Tel: 01 295 9673 Fax: 01 295 4671

E-mail: legrand.sales@legrand.co.uk



FOLLOW
US AT

@	www.legrand.co.uk www.legrand.ie
YouTube	www.youtube.com/legrandtvuk
voltimum	www.voltimum.co.uk www.voltimum.ie
Twitter	www.twitter.com/legranduk
LinkedIn	www.linkedin.com/ company/legranduk



Head office (UK and Ireland):

Legrand Electric Limited

Great King Street North, Birmingham, B19 2LF

Tel: +44 (0) 370 608 9000 Fax: +44 (0) 370 608 9004

Website: www.legrand.co.uk

Global strength built on local knowledge

Legrand is the global specialist in electrical and digital building infrastructures. Innovation is the driving force behind its development.

With an increasing investment in research and development (circa 5% of sales) and around 3,900 active patents, the Legrand Group is focused on maintaining a high rate of new product launches that present innovative solutions to the market.

CORPORATE SOCIAL RESPONSIBILITY

Legrand's CSR roadmap is a natural extension to the governance and sustainable development approach in which the company has been engaged for many years. The CSR roadmap firmly asserts Legrand's ongoing commitment to sustainable development.

Respect human rights and communities
Ensure health, safety and well-being
Develop skills
Promote equal opportunity and diversity



Provide sustainable solutions
Ensure sustainable procurement
Act ethically

Mitigate climate change
Innovate for the circular economy
Prevent pollution



SMART HOMES

made accessible



Arteor with Netatmo forms part of Legrand's Eliot programme. The programme is dedicated to developing sustainable connected solutions that are easy to use and maintain, accessible for everybody and customisable to the users' needs, desires and habits. To enhance the value of any home and make everyday life just that little bit more comfortable and secure.

FEATURES & FUNCTIONS

Introduction	4-5
Lighting control	6-7
Centrally controlled lighting	8
Smart blind control	9
Scenario switches	10-11
Connected socket outlets	12-13
Wired and wireless controls	14-17
Five steps to a connected home	18-19
Smarthome via a smartphone	20-21
Voice control	22-23
Technology meets design	24-25
Smarter with Netatmo - the new connected thermostat	26

PRODUCT SELECTION

Connected gateway	27
Connected wired light switches	28
Connected socket outlets	29
Connected contactor and electricity meter	30
Connected curtain/blind switches	30
Connected wireless controls	31
Connected wireless scene switches	32
Connected wireless curtain/blind controls	33
International support frames and blank modules	33
Arteor™ surround plate selection chart	34-35

CONTENTS



CONNECTED LIVING

LIFE CAN BE THIS
SIMPLE

ARTEOR™ WITH Netatmo

In today's world, digitalisation and networking are simplifying our lives and adding greater convenience. As technology transforms the way we work, communicate, travel and live, it also brings greater complexity. This is why Legrand has sought to make networked digital technology as easy as possible for designers, installers and users.

The result is the Arteor with Netatmo solution, which combines innovative Netatmo smart home technology with Legrand's elegant and modular wiring accessories. Enhancing individual comfort and security in the connected home, it is quick and easy to install and will adapt to changing habits and needs over time.

All functions in an Arteor with Netatmo installation can be controlled on a smartphone or tablet via the Home + Control app, available for Android and iOS devices. The app allows users to conveniently turn individual lights on or off, control blinds, curtains and electrical appliances or trigger more complex scenarios.

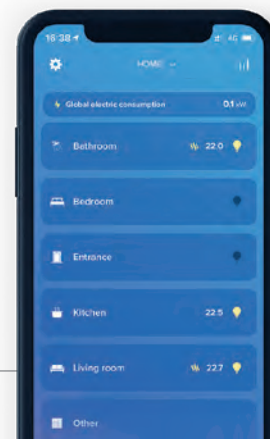



Zigbee/ Wi-Fi gateway
see p. 27

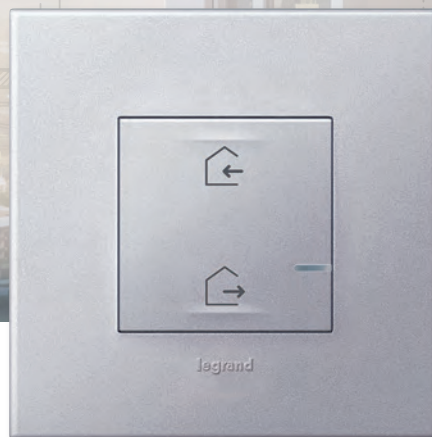

Wireless home/away master switch
see p. 32



Connected socket outlet
see p. 29

THE SMART RADIO SOLUTION



Arteor with Netatmo is a radio-based solution for the connected home. The intelligent products communicate with one another via radio Zigbee (2.4 GHz waveband), meaning there is no need for specific or extensive cabling. The products can be used to create individual solutions for a more customised feel at home.

SIMPLE, ADAPTABLE AND OPEN

Arteor with Netatmo has been designed and developed as a simple solution to make every house more individual, convenient and secure. Simple for designers, who are able to integrate many useful functions without having to provide for complicated cabling. Simple for installers, who are able to install the system without a great deal of effort or specialist knowledge. Simple for users, who will find it convenient to operate, easy to extend and are able to make changes at any time. The Works with Legrand programme and Zigbee 3.0 certification allows the Arteor with Netatmo system to integrate and enhance third-party solutions. Find out more at legrand.co.uk.

LIGHTING CONTROL

SIMPLY INTELLIGENT



Connected wired switch without neutral,
with dimmer option
see p. 28



Connected wired switch with neutral,
with dimmer option
see p. 28



Wireless light switch
see p. 31

MORE THAN JUST ON OR OFF

With the integrated dimmer function, switches no longer just turn a light on or off, use them to create different lighting moods to suit every occasion. The switches with dimmer option are available with or without a neutral. They are designed for all modern light sources, including dimmable LEDs, which allow a flexible lighting system to help save energy. They can be controlled by one or more wireless light switches offering complete freedom for design and planning, whether it's a new build or renovation project.





Connected wired switch with neutral
see p. 28

Wireless light switch
see p. 31

CONVENIENT, CONNECTED LIGHTING

Arteor with Netatmo switches with dimmer option have a handy memory level function, so the light comes back on again at the same level of brightness as when it was switched off. For ultimate convenience just use the Home + Control app to create any lighting mood using a smartphone.

**Micromodule switch -
to connect lights
with a ceiling box
installation, see p. 28**



The lighting micromodule is installed in the ceiling box near the light. This makes it possible to transform a conventionally installed light into a convenient connected light, without any need for expensive rewiring.

Wireless flush mounting switch

The wireless switch, which can be installed in the flush mounting box, easily expands the options of a wired lighting system without compromising on aesthetics. See p. 31



CENTRALLY CONTROLLED

LIGHTING OPTIONS



Wireless light switch
see p. 31

LIGHTING MANAGEMENT MADE EASY

Compatible with the Arteur with Netatmo and EDMX³ with Netatmo gateways, the CX³ with Netatmo connected latching relay is installed in the electrical enclosure. The connected latching relay can be controlled by either wired mechanical push buttons or wireless light switches. In either case, lighting can be controlled via the Home + Control app or by voice. Whether by individual control, integration into scenarios, or preprogrammed daily or weekly routines that are easy to set up – the choice is there. Energy consumption can also be monitored on the app, helping towards targeted energy savings.



CX³ with Netatmo
connected latching relay
see p. 28

SMART BLIND CONTROL

SIMPLY CONVENIENT



Connected wired curtain/blind switch
see p. 30



Wireless curtain/blind switch
see p. 33

The regular opening and closing of curtains and blinds is made much more convenient by Arteor with Netatmo. In addition, the connected curtain/blind switches offer a stop function and level management.

A single wireless control can manage up to 20 wired curtain/blind switches, so that a touch of a button operates whole groups of curtains or blinds in centralised mode, or as part of preprogrammed scenarios. Opt for even more convenience by choosing to control the system using the Home + Control app or virtual assistants.



Flush mounting wireless
curtain/blind switch, see p. 33

SCENARIO SWITCHES

MORE OPTIONS FOR A MORE PERSONAL TOUCH



Wireless home/away master switch
see p. 32



Wireless wake up/sleep switch
see p. 32

For regular everyday situations, scenarios provide time-saving convenience to simplify daily life. The switches have scenarios that are ready for programming and can easily be personalised in the Home + Control app to suit individual needs. For example, users can simply press a switch by the door to open the blinds and turn on the lights when arriving home. Similarly, when leaving the house, one push of a button is enough to close all blinds and turn off the lights.

FOUR CUSTOMISABLE SCENARIOS

The Arteor with Netamo wireless 4 scenes switch allows four individual scenarios to be programmed as the user wishes. The app can be used to assign names as well as specific icons. With configuration made that easy there's no need to worry about changing the scenarios at a later stage. See p. 32

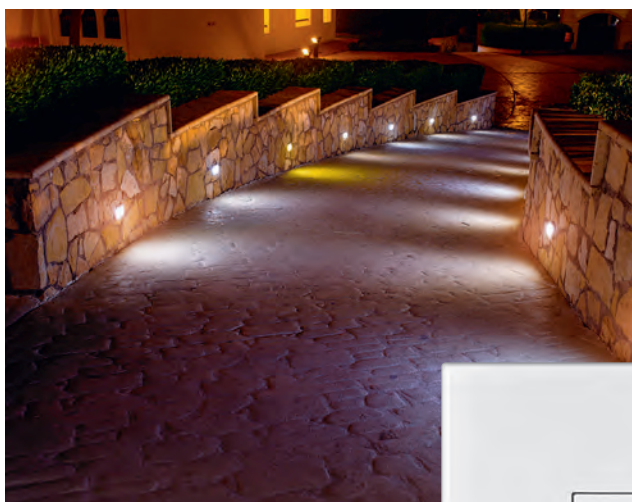

Arriving home



Working from home



Relaxing evening in



Dining

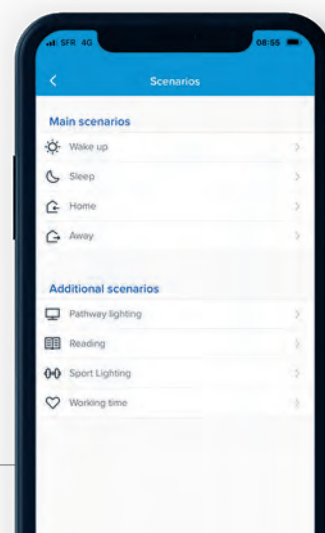

CONNECTED SOCKET OUTLETS

REMOTE CONTROL
MADE EASY



Connected switched socket outlet 13 A - 2 gang
see p. 29



Connected switched socket outlet 13 A - 1 gang
see p. 29

MORE FREEDOM IN PLANNING AND IN USE

Arteor with Netatmo turns socket outlets into smart components of the connected home. This allows any type of electrical appliance to be switched on and off remotely or integrated into individual scenarios. Connected socket outlets are controlled using switches that can be positioned freely on the wall, using the Home + Control app or virtual assistants. In addition, the connected sockets provide useful information about weekly and monthly energy consumption and will send an error message to a smartphone in the event of any problem, so users can take the appropriate action.





A POWERFUL SOLUTION FOR LOADS UP TO 20 A

Using the CX³ with Netatmo connected contactor in combination with the Arteor with Netatmo or EDMX³ with Netatmo gateway, even high-power consuming devices can be operated safely from a distance and integrated into the smart home installation. Whether they are being used to control water heaters or electric vehicle chargers for example, users can rely on the convenience of remote control and preprogrammed processes. Energy consumption can also be monitored on the app, helping towards targeted energy savings.

CX³ with Netatmo connected contactor
For specific circuits up to 20 A
see p. 30



FEW COMPONENTS

MORE OPTIONS

The Arteor with Netatmo system consists of a few simple components. A gateway pack or DIN rail gateway needs to be installed to start, along with connected controls which trigger actions such as controlling lights, curtains or blinds and electrical appliances. They manage scenarios, create centralised functions and allow remote control of individual actions.

CONNECTED WIRED PRODUCTS

The wired products are installed in the same way as conventional components and then paired with the wireless switches (which can be positioned anywhere) via the Zigbee 2.4 Ghz waveband. Thanks to the dynamic mesh network, all functions can easily be reconfigured at any time. It is also easy to add extra modules.

START



Gateway pack see p. 27

Wireless device (battery powered)

or

EDMX³ with Netatmo DIN rail gateway see p. 27

The Home + Control app, which can be used to control the system via smartphone and tablet, is available for Android and iOS devices. Download it for free from your usual app stores.

Download on the App Store GET IT ON Google Play

HOME + CONTROL app

A gateway creates the radio network and the Wi-Fi connection of the connected installation. The gateway pack consists of a Zigbee/Wi-Fi gateway and a home/away wireless master switch.

FUNCTIONS

Wired devices (230 V AC)

LIGHT

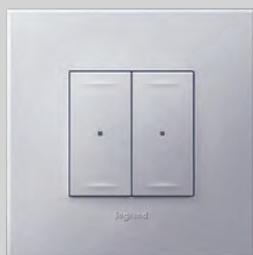

Connected wired light switch with or without neutral and dimmer options see p. 28



Micromodule switch see p. 28



CX³ with Netatmo connected latching relay see p. 28

CURTAINS/BLINDS



Connected wired curtain/blind switch see p. 30



Connected curtain/blind micromodule see p. 30

CONNECTED OUTLETS



Connected socket outlet 1 gang and 2 gang see p. 29



Connected mobile socket outlet see p. 29



CX³ with Netatmo connected contactor see p. 30

FEW COMPONENTS

MORE OPTIONS

FUNCTIONS

LIGHT

SURFACE MOUNTING



Wireless 1 gang and 2 gang light switches see p. 31

FLUSH MOUNTING



Wireless light switch - 1 module see p. 31

CURTAINS/

SURFACE MOUNTING



Wireless curtain/blind switch - 1 gang see p. 33

WIRELESS CONTROLS

Wireless light and curtain/blind switches are used to extend the installation and enable individual, group-based or centralised remote control of lighting, curtains and blinds. They can adapt to changes to the installation over time. Wireless scenario controls are used to activate preprogrammed, more complex scenarios that enhance comfort when you wake up in the morning or go to bed at night, leave the house or come home. Additionally, the wireless 4 scenes switch allows four individual scenarios to be programmed.

Wireless devices (battery powered)

BLINDS

FLUSH MOUNTING



Wireless curtain/blind switch - 1 module
see p. 33

SCENARIOS

SURFACE MOUNTING



Wireless home/away master switch - 1 gang, see p. 32



Wireless wake up/sleep switch - 1 gang, see p. 32



Wireless 4 scenes switch
see p. 32

FLUSH MOUNTING



Wireless home/away master switch - 1 module, see p. 32



Wireless wake up/sleep switch - 1 module, see p. 32

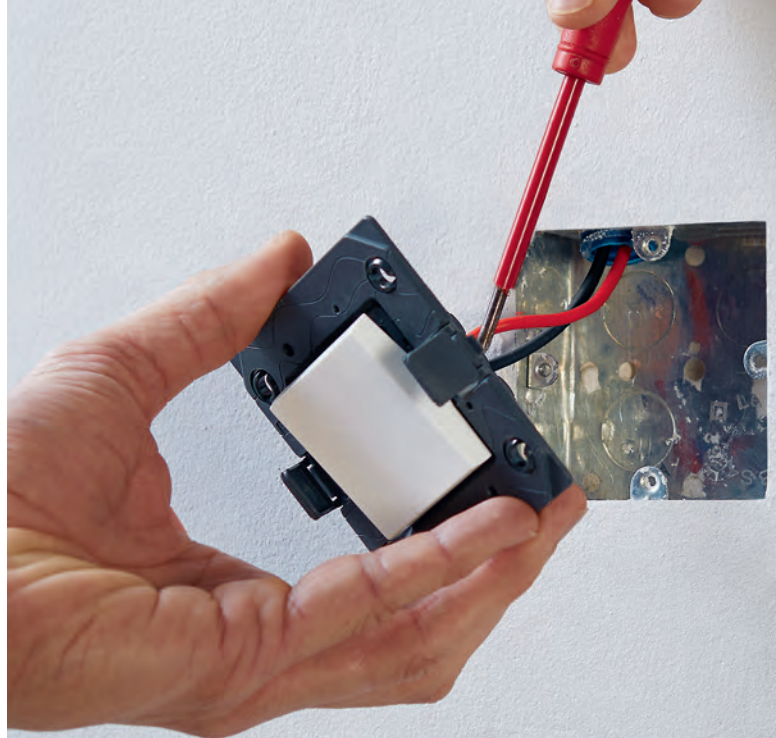

NOTE: Refer to local wiring regulations for guidance on electrical cable types in your country.

EASY INSTALLATION

FOR NEW BUILDS AND RENOVATIONS

FIVE STEPS TO A CONNECTED HOME

1

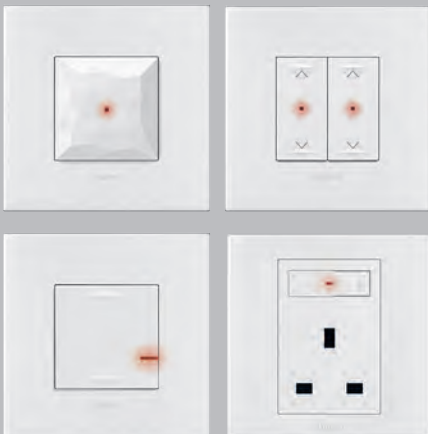

Once all wired devices are installed and the power is on, all LEDs will light up in red.

2

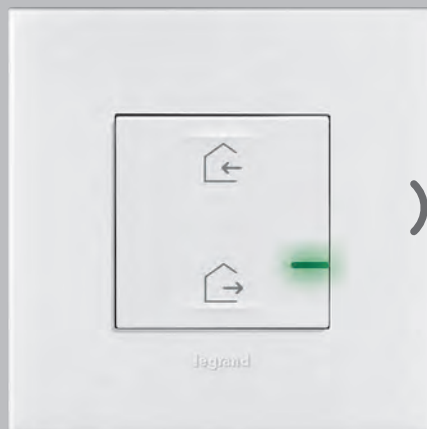

Press the master switch in the centre and hold for 5 seconds.

3



The LEDs now light up in green, showing that the network has been created.

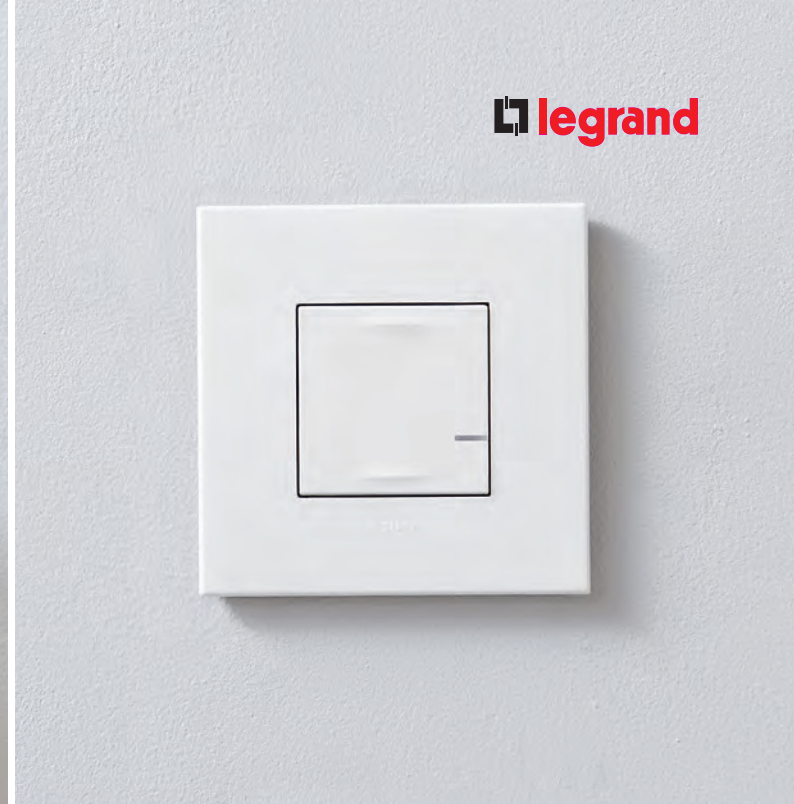
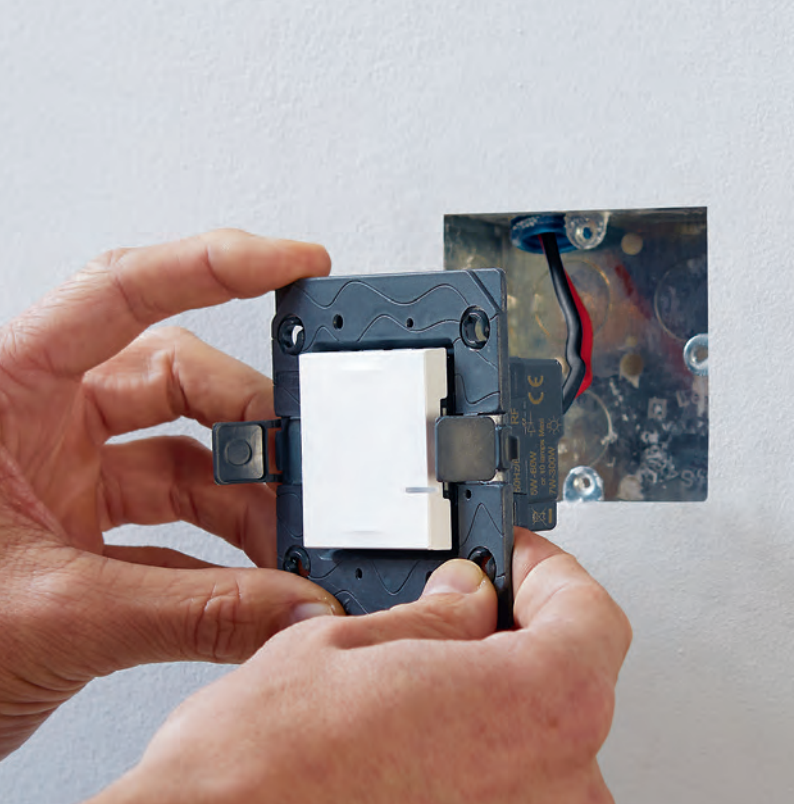

Arteor with Netatmo is a radio solution that requires no extra wiring, as it uses the existing infrastructure. This makes it the ideal choice for upgrading an existing installation into a connected home. For new building projects, it offers a range of benefits such as reduced labour time thanks to its simple installation.

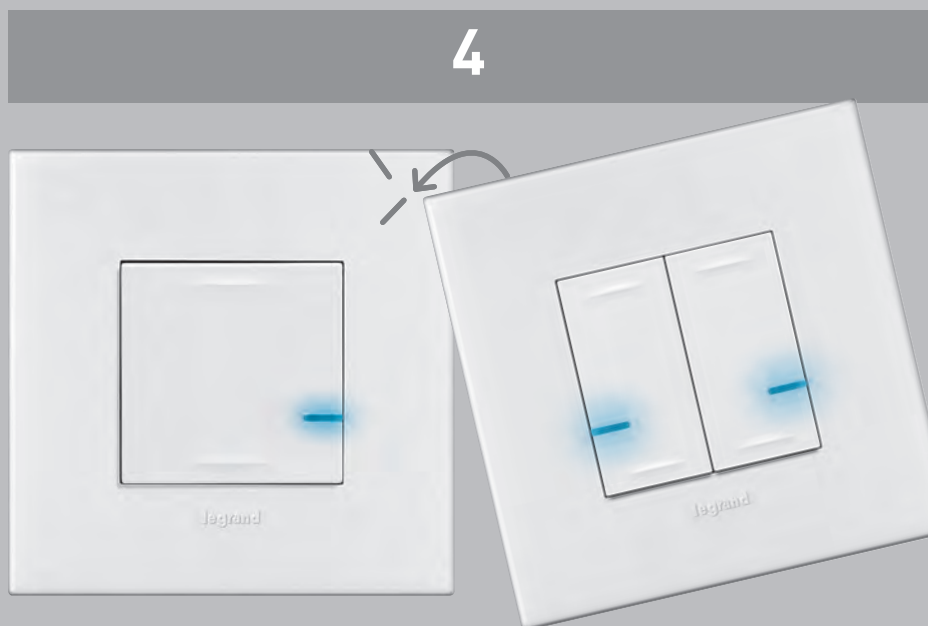

To add a wireless switch, press and hold the switch while tapping it three times onto the wired device. The LED's blue light indicates that the pairing was successful.



After a short press on the master switch, all LEDs will turn off.

SMARTHOME VIA SMARTPHONE

ADD A TOUCH
OF SMARTNESS

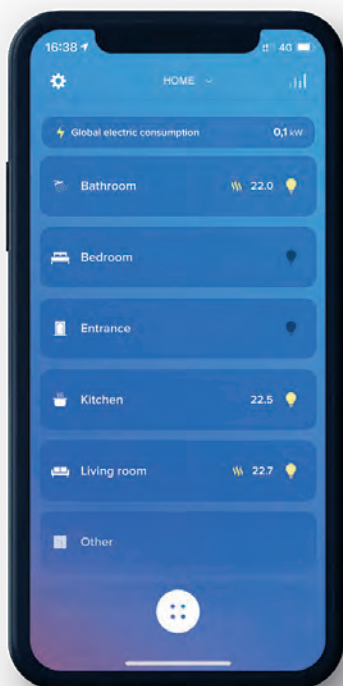

The Home + Control app changes everything, not only in terms of control of the smart home but also in terms of its configuration. The app can be used to conveniently configure the entire system, based on individual preferences. Create tailored scenarios, remotely control individual devices and monitor energy consumption.



The same app used by the installer for configuration is also used by the end user to control the entire system. The remote control options it provides are particularly useful. The app displays smart alerts if, for instance, the refrigerator loses power or a light is left on when nobody is home. This allows the user to remotely control the system and act accordingly.

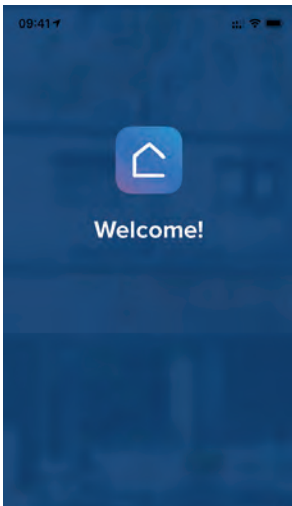

Configuration is based on a set of simple steps

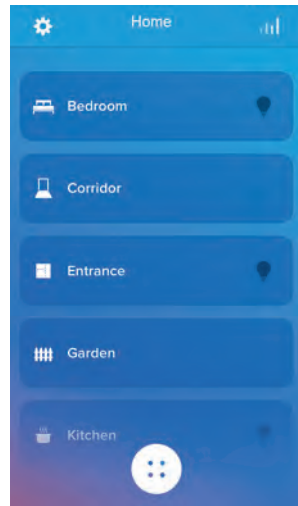

Each room is configured individually

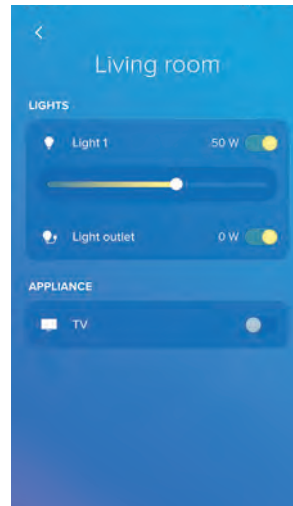

All functions can be set individually

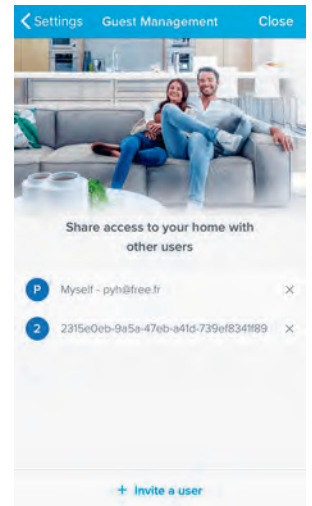

Users can invite each member of their family



Energy consumption can be monitored for individual devices

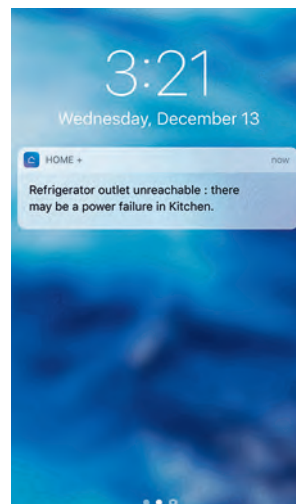

Enables fast response to faults

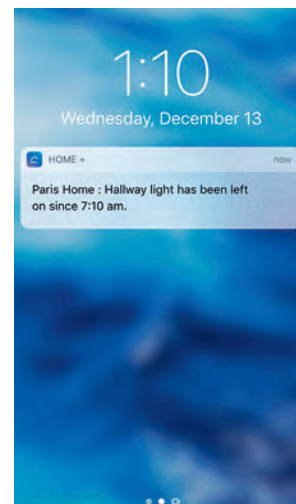

Smart alerts reach the user wherever they may be

VOICE CONTROL

ADD A VIRTUAL ASSISTANT

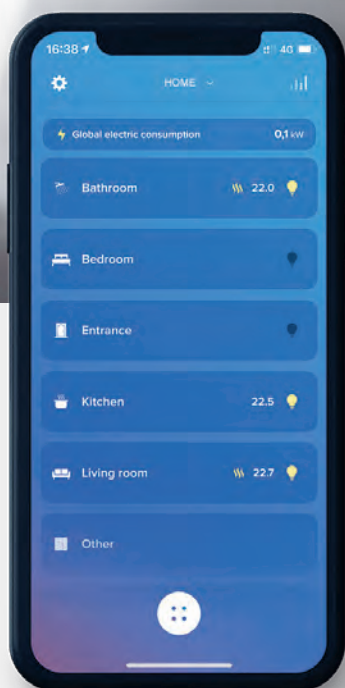

As modern home technology becomes increasingly complex, it also becomes easier to operate. Arteor with Netatmo makes it possible to control functions via virtual assistants. Used in combination with Google Assistant, Amazon Alexa or Apple Siri, the system listens for the command, such as “Turn on the living room lights”, and reacts accordingly.



Connected wired and wireless controls for local and remote control, see p. 28, 31-33

EASY TO USE ANY WAY YOU LIKE

Arteor with Netatmo makes it possible to control all connected devices using virtual assistants: Google Assistant, Amazon Alexa and Apple Siri. Voice control enables users to easily switch the lights on or off, run scenarios or set the desired temperature hands-free.

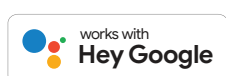

TECHNOLOGY MEETS DESIGN

ADD A TOUCH
OF STYLE

NEUTRAL



Champagne



White



Graphite



Soft Alu



Magnesium



Dark Bronze

BRUSHED METAL



Black



Stainless Steel



Gold Brass



Pink Champagne

REFLECTIVE METAL



Black



Stainless Steel



Gold

MIRROR



Mirror Black



Mirror White

WOOD



Grey Oak

SIGNATURE



Cube



THE NEW CONNECTED THERMOSTAT Smarter

WITH
Netatmo

The Smarter with Netatmo connected thermostat monitors and controls the temperature of the home simply. With the Home + Control app and compatibility with virtual assistants, users have smart management of their home temperature.

Find out more at [legrand.co.uk](https://www.legrand.co.uk)



The Home + Control app is available on



Connected home

connected gateway

Connected installations
require a gateway module

Step 1: Gateway for a connected home



5742 09



4121 81

Support frames and surround plates selection chart **p. 34 to 35**

Used to create the radio network and the Wi-Fi connection of the connected installation
Enables remote control of the home (lighting, blinds and electrical appliances) using a smartphone via the Home + Control app and/or voice control using a virtual assistant

Must be ordered to start any connected installation
To be completed by adding individual connected products
2.4 GHz Wi-Fi connection required

Pack	Cat. Nos.	Connected gateway pack
1	5742 09	<p>Composition:</p> <ul style="list-style-type: none"> - 1 flush mounted Zigbee/Wi-Fi gateway Mechanisms supplied with integrated plastic cover and to be equipped with support frames (p. 33) and surround plates (p. 34 to 35) Can be installed in place of an existing product Suitable for flush mounting box with recommended depth of 47 mm - 1 home/away wireless master switch with customisable preset life scenes Supplied with integrated plastic cover and multi-standard support frame (with removable fins) To be equipped with 2 module surround plates (p. 34 to 35) Used to create the radio network and to control life scenes Supplied with CR2032 3 V long-life battery for power supply and 2 removable stickers for fixing the control unit on any substrate LED function for low battery indication <ul style="list-style-type: none"> ○ White ● Magnesium ● Champagne ● Soft Alu
1	5742 27	
1	5742 36	
1	5742 18	

Pack	Cat. Nos.	EMDX ³ with Netatmo DIN rail gateway module
1	4121 81	<p>For installation in the electrical panel with DIN rail support 100 - 240 V\sim - 50/60 Hz Consumption: 2 W maximum Connection via screw terminals Width: 2.5 x 17.5 mm modules</p>

Legrand's Home + Control app available on
Google Play and the App Store



Arteor with Netatmo is part of Legrand's Eliot programme, dedicated to developing sustainable, connected solutions
For availability and support please contact our Technical Department on
+44 (0) 370 608 9020

Connected home

connected wired light switches

Step 2: Connected products



5742 01



5742 12



5743 40



5742 43



4121 70

Support frames and surround plates selection chart **p. 34 to 35**

Used to create a connected home. Requires prior installation of a Netatmo gateway module (p. 27)

Pack	Cat. Nos.	Connected wired light switches
		Switch with neutral 250 W - 1 module
		Mechanisms supplied with integrated plastic cover and to be equipped with support frames (p. 33) and surround plates (p. 34 to 35) For local or remote control of lighting Can be controlled by one or more wireless light switches or mechanical 2 way switches Compatible with all loads Can be installed in place of an existing switch in a flush mounting box with recommended depth of 47 mm Locator/indicator function can be activated from the Home + Control app Zigbee Certified Product
1	5742 01	○ White
1	5742 20	● Magnesium
1	5742 29	● Champagne
1	5742 11	● Soft Alu
		Switch without neutral 5 - 300 W with dimmer option - 2 modules
		Mechanisms supplied with integrated plastic cover and to be equipped with support frames (p. 33) and surround plates (p. 34 to 35) For local or remote ON/OFF or dimming control of lighting Can be controlled by one or more wireless light switches Dimmer mode and locator/indicator function can be activated from the Home + Control app Compatible with all loads: - Dimmable LEDs: 50 W - Halogen with transformer: 300 VA - Fluorescent tube: 300 VA - Halogen 230 V~ and incandescent: 300 W Supplied with a bleeder (synthetic load) Memory level function Can be installed in place of an existing switch in a flush mounting box with recommended depth of 47 mm Zigbee Certified Product
1	5742 02	○ White
1	5742 21	● Magnesium
1	5742 30	● Champagne
1	5742 12	● Soft Alu

Pack	Cat. Nos.	Connected wired light switches
		Switch with neutral 150 W with dimmer option - 1 module
		Mechanisms supplied with integrated plastic cover and to be equipped with support frames (p. 33) and surround plates (p. 34 to 35) For local or remote ON/OFF or dimming control of lighting Can be controlled by one or several wireless light switches or mechanical push buttons without neon Dimmer mode and locator/ indicator function can be activated from the Home + Control app Compatible with all loads: - Dimmable LEDs: 150 W - Halogen with transformer: 150 VA - Fluorescent tube: 150 VA - Halogen 230 V~ and incandescent 150 W Memory level function Can be installed in place of an existing switch in a flush mounting box with recommended depth of 47 mm Zigbee Certified Product
1	5743 40	○ White
1	5743 42	● Magnesium
1	5743 43	● Champagne
1	5743 41	● Soft Alu
		Micromodule switch with neutral 300 W
1	5742 43	Used to connect lights with a ceiling box installation Can be controlled by one or more wireless light switches or mechanical push buttons Paired by tapping the wireless control on the micromodule Zigbee Certified Product
		CX³ with Netatmo connected latching relay
1	4121 70	Can be controlled by standard wired push buttons and/or be combined with Arteor with Netatmo connected wireless switches Self-protected upstream control terminals: no need for protection such as a 2 A circuit breaker or a fuse Silent latching relay (< 10 dB) Single pole, 16 A, 100 - 240 V~ - 50/60 Hz Conforms to standard: IEC/EN 60669-2-1 Allows the user via the Legrand Home + Control app to: - Control devices remotely (one-off control or integrated in a scenario with one or more lighting points) - Measure and track consumption (kWh) of the controlled circuit - Programme devices according to a daily and/or weekly schedule Connection via screw terminals Width: 1 x 17.5 mm module

Connected home

connected outlets

Step 2: Connected products



5742 57 +
Soft Alu surround plate 5713 03



5742 66



0648 89



0648 79

Support frames and surround plates selection chart **p. 34 to 35**

Used to create a connected home. Requires prior installation of a Netatmo gateway module (p. 27)

Pack	Cat. Nos.	Connected socket outlets 13 A - 250 V~ single pole switch
		<p>Conform to BS 1363 Part-2 ASTA licence Shuttered for child safety Protected against overloads Socket outlets can be controlled by one or several wireless ON/OFF controls Remote control via the Home + Control app Compatible with any electrical appliance or large household appliance Connected socket outlets allow to:</p> <ul style="list-style-type: none"> - Remotely control electrical appliances - Measure instantaneous power - Monitor daily and monthly consumption - Send notifications in case of abnormal use (overconsumption etc.) <p>Can be installed in place of an existing socket outlet in a flush mounting box with recommended depth of 35 mm Indicator LED function can be activated from the Home + Control app Zigbee Certified Product</p> <p>2P + E switched - 1 gang Mechanisms supplied with integrated plastic cover and support frames To be equipped with surround plates - 1 gang 3 modules (p. 34-35)</p>
1	5742 56	<ul style="list-style-type: none"> ○ White ● Magnesium ● Champagne ● Soft Alu
1	5742 58	
1	5742 59	
1	5742 57	
		<p>2P + E switched - 2 gang Mechanisms supplied with integrated plastic cover and support frames To be equipped with surround plates (p. 34-35), only suitable for use with 2P + E switched sockets</p>
1	5742 66	<ul style="list-style-type: none"> ○ White ● Magnesium ● Champagne ● Soft Alu
1	5742 68	
1	5742 69	
1	5742 67	

Pack	Cat. Nos.	Connected mobile socket outlet
		<p>To be plugged directly into an existing socket outlet For control of lights, electrical appliances and large household appliances Connected mobile socket outlets can be controlled by wireless ON/OFF controls ON/OFF indicator LED function Connected mobile socket outlets allow to:</p> <ul style="list-style-type: none"> - Remotely control electrical appliances - Measure instantaneous power - Monitor daily and monthly consumption - Send notifications in case of abnormal use (overconsumption etc.) <p>Indicator LED function can be activated from the Home + Control app Zigbee Certified Product</p>
1	0648 89	<p>13 A connected mobile socket outlet - 3000 W ● Magnesium</p>
		<p>Cable outlet Enables remote control of electrical devices Wiring compatible with pilot wire Can be controlled by a wireless ON/OFF control 3000 W max. (protected against overloads) Functions:</p> <ul style="list-style-type: none"> - ON/OFF, pilot wire management - Instantaneous power measurement and daily/monthly consumption monitoring with configurable sending of notifications (defect, consumption, etc.) <p>Supplied with mounting support, cover plate and worksite protection Multi-gang fixing not possible Zigbee Certified Product</p>
1	0648 79	<ul style="list-style-type: none"> ○ White ● Magnesium ● Champagne ● Soft Alu
1	0648 83	
1	0648 82	
1	0648 98	

Connected home

connected contactor and energy meter

Step 2: Connected products



4121 71

4120 15

Used to create a connected home. Requires prior installation of a Netatmo gateway module (p. 27)

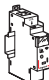
Pack	Cat. Nos.	
1	4121 71	<p>CX³ with Netatmo connected contactor</p>  <p>Multifunction silent contactor (< 10 dB) 20 A, 100 - 240 V~ - 50/60 Hz Conforms to IEC/EN 60669-2-1 Can be used to control (ON/OFF) any type of load remotely (water heater, heating, swimming pool pump, charging socket for an electric vehicle, etc) Peak/off-peak function Allows the user via the Legrand Home + Control app to:</p> <ul style="list-style-type: none"> - Set the contactor operating mode (peak/off-peak or ON/OFF) according to the nature of the load (water heater or other load) - Measure and track consumption (kWh) of the controlled circuit - Control another single or three phase contactor > 20 A - Directly control electrical appliance up to 4800 W, or motors up to 2400 VA, or sockets for electric vehicles up to 16 A EV <p>Self-protected upstream control terminals: no need for protection such as a 2 A circuit breaker or a fuse Screw terminals Width: 1 x 17.5 mm module</p>
1	4120 15	<p>EMDX³ with Netatmo connected energy meter</p>  <p>Maximum circuit rating 80 A Supplied with 1 closed current transformer Allows the user to:</p> <ul style="list-style-type: none"> - Measure the total instantaneous power consumption of an alternating single phase circuit - Track the daily/weekly/monthly/annual history of the total consumption of the circuit with which it is associated (in kWh and as a value) - Send a notification if an adjustable threshold of total instantaneous power is reached <p>100 - 240 V~ - 50/60 Hz Width: 1 x 17.5 mm module</p>

Connected home

connected curtain/blind switches



Step 2: Connected products

Home + Control
LEGRAND

5742 04

 Support frames and surround plates selection chart **p. 34 to 35**

Used to create a connected home. Requires prior installation of a Netatmo gateway module (p. 27)

Pack	Cat. Nos.	
1	5742 04	<p>Connected wired curtain/blind switch</p> <p>Mechanisms supplied with integrated plastic cover and to be equipped with support frames (p. 33) and surround plates (p. 34 to 35) For local and remote control of a 230 V~ curtain/blind (open/close/stop functions and level management) Compatible with blinds with mechanical or electronic stop, not compatible with radio-controlled curtain/blind Can be paired with one or more wireless curtain/blind switches Can be installed in place of an existing curtain/blind switch in a flush mounting box with recommended depth of 47 mm Zigbee Certified Product 1 module - with neutral</p>  <ul style="list-style-type: none"> ○ White ● Magnesium ● Champagne ● Soft Alu
1	5742 22	
1	5742 31	
1	5742 13	
1	0676 97	<p>Connected wired curtain/blind micromodule IP 44</p>  <p>For local and remote control of a 230 V~ curtain/blind (open/close/stop functions and level management) Compatible with curtains/blinds with mechanical or electronic stop, not compatible with radio-controlled curtains/blinds Can be paired with one or more curtain/blind wireless switches To be installed in the ceiling box or curtain/blind box to connect a new or existing curtain/blind Zigbee Certified Product</p>

Connected home

connected wireless controls

Step 2: Connected products



5742 05



5742 47



5742 91



5742 52

Support frames and surround plates selection chart **p. 34 to 35**

Used to create a connected home. Requires prior installation of a Netatmo gateway module (p. 27)

Pack	Cat. Nos.	Wireless light switches	Pack	Cat. Nos.	Wireless motion sensor IP 44	
1	5742 05	<p>Used to add extra lighting control Easy pairing by tapping the wired product or by using the Home + Control app Supplied with CR2032 3 V long-life battery for power supply LED function for low battery indication Zigbee Certified Product</p> <p>Surface mounting version - 1 gang Supplied with integrated plastic cover, multi-standard support frame (with removable fins) and 2 removable stickers for fixing the control unit on any substrate To be equipped with 2 module surround plates (p. 34 to 35) Controls up to 20 wired products: switches, micromodules, socket outlets</p> <p> ○ White ● Magnesium ● Champagne ● Soft Alu</p> <p>Surface mounting version - 2 gang Supplied with integrated plastic cover, multi-standard support frame (with removable fins) and 2 removable stickers for fixing the control unit on any substrate To be equipped with 2 module surround plates (p. 34 to 35) Controls up to 2 x 20 wired products: switches, micromodules, socket outlets</p> <p> ○ White ● Magnesium ● Champagne ● Soft Alu</p> <p>Flush mounting version - 1 module Mechanism supplied with integrated plastic cover and to be equipped with support frames (p. 33) and surround plates (p. 34 to 35) Controls up to 20 wired products: switches, micromodules, socket outlets Can be installed in a flush mounting box, in addition to wired products with recommended depth of 47 mm</p> <p> ○ White ● Magnesium ● Champagne ● Soft Alu</p>	1	5742 52	<p> Allows to control up to 20 wired switches, micromodules and socket outlets Easy pairing by tapping the wired products or by using the Home + Control app Supplied with 2 x AA battery For indoor and outdoor use Recommended distance between 2 sensors: 6 m Recommended installation height: 2.5 m Time delay adjustable from 15 s to 15 min Range: 8 m Detection angle: 140° Sensor range adjustable from 2 m to 8 m Light level threshold adjustable from 1 to 1000 lux Zigbee Certified Product</p>	
1	5742 23			1	0676 94	<p> Allows to transform a mechanical 2 way switch or push button into a wireless on/off switch. Small size for easy integration into the wall box To be paired with one connected switch, micromodule, socket outlet Supplied with CR2032 3 V long-life battery for power supply Zigbee Certified Product</p>
1	5742 32					
1	5742 14					
1	5742 44					
1	5742 46					
1	5742 47					
1	5742 45					
1	5742 91					
1	5742 76					
1	5743 26					
1	5742 75					

Connected home

connected wireless scene switches

Step 2: Connected products



5742 15



5742 70



5742 08



5742 73



5743 12 +
White surround plate 5752 10

Support frames and surround plates selection chart **p. 34 to 35**

Used to create a connected home. Requires prior installation of a Netatmo gateway module (p. 27)

Pack	Cat. Nos.	Wireless home/away master switches
1	5742 06	<p>Used to add a home/away wireless master switch to the EDMX³ with Netatmo gateway module (p. 27) or an extra module for the gateway pack (p. 27)</p> <p>Works in the same way as the home/away wireless master switch included in the gateway pack</p> <p>Home/away life scenes can be customised in the Home + Control app</p> <p>Supplied with CR2032 3 V long-life battery for power supply</p> <p>LED function for low battery indication</p> <p>Zigbee Certified Product</p> <p>Surface mounting version - 1 gang</p> <p>Supplied with integrated plastic cover, multi-standard support frame (with removable fins) and 2 removable stickers for fixing the control unit on any substrate</p> <p>To be equipped with 2 module surround plates (p. 34 to 35)</p> <p> ○ White ● Magnesium ● Champagne ● Soft Alu</p> <p>Flush mounting version - 1 module</p> <p>Mechanism supplied with integrated plastic cover and to be equipped with support frames (p. 33) and surround plates (p. 34 to 35)</p> <p>Can be installed in a flush mounting box with recommended depth of 47 mm</p> <p> ○ White ● Magnesium ● Champagne ● Soft Alu</p>
1	5742 24	
1	5742 33	
1	5742 15	
1	5742 70	<p>Used to add a home/away wireless master switch to the EDMX³ with Netatmo gateway module (p. 27) or an extra module for the gateway pack (p. 27)</p> <p>Works in the same way as the home/away wireless master switch included in the gateway pack</p> <p>Home/away life scenes can be customised in the Home + Control app</p> <p>Supplied with CR2032 3 V long-life battery for power supply</p> <p>LED function for low battery indication</p> <p>Zigbee Certified Product</p> <p>Surface mounting version - 1 gang</p> <p>Supplied with integrated plastic cover, multi-standard support frame (with removable fins) and 2 removable stickers for fixing the control unit on any substrate</p> <p>To be equipped with 2 module surround plates (p. 34 to 35)</p> <p> ○ White ● Magnesium ● Champagne ● Soft Alu</p> <p>Flush mounting version - 1 module</p> <p>Mechanism supplied with integrated plastic cover and to be equipped with support frames (p. 33) and surround plates (p. 34 to 35)</p> <p>Can be installed in a flush mounting box with recommended depth of 47 mm</p> <p> ○ White ● Magnesium ● Champagne ● Soft Alu</p>
1	5742 79	
1	5743 27	
1	5742 97	

Pack	Cat. Nos.	Wireless wake up/sleep switches
1	5742 08	<p>Used to add 2 extra scenes to a connected installation</p> <p>Preset wake up/sleep life scenes which can be customised in the Home + Control app</p> <p>Supplied with CR2032 3 V long-life battery for power supply</p> <p>LED function for low battery indication</p> <p>Zigbee Certified Product</p> <p>Surface mounting version - 1 gang</p> <p>Supplied with integrated plastic cover, multi-standard support frame (with removable fins) and 2 removable stickers for fixing the control unit on any substrate</p> <p>To be equipped with 2 module surround plates (p. 34 to 35)</p> <p> ○ White ● Magnesium ● Champagne ● Soft Alu</p> <p>Flush mounting version - 1 module</p> <p>Supplied with integrated plastic cover and to be equipped with support frames (p. 33) and surround plates (p. 34 to 35)</p> <p>Can be installed in a flush mounting box in addition to wired products with recommended depth of 47 mm</p> <p> ○ White ● Magnesium ● Champagne ● Soft Alu</p>
1	5742 26	
1	5742 35	
1	5742 17	
1	5742 73	<p>Used to add 2 extra scenes to a connected installation</p> <p>Preset wake up/sleep life scenes which can be customised in the Home + Control app</p> <p>Supplied with CR2032 3 V long-life battery for power supply</p> <p>LED function for low battery indication</p> <p>Zigbee Certified Product</p> <p>Surface mounting version - 1 gang</p> <p>Supplied with integrated plastic cover, multi-standard support frame (with removable fins) and 2 removable stickers for fixing the control unit on any substrate</p> <p>To be equipped with 2 module surround plates (p. 34 to 35)</p> <p> ○ White ● Magnesium ● Champagne ● Soft Alu</p> <p>Flush mounting version - 1 module</p> <p>Supplied with integrated plastic cover and to be equipped with support frames (p. 33) and surround plates (p. 34 to 35)</p> <p>Can be installed in a flush mounting box in addition to wired products with recommended depth of 47 mm</p> <p> ○ White ● Magnesium ● Champagne ● Soft Alu</p>
1	5742 90	
1	5743 28	
1	5742 98	

Pack	Cat. Nos.	Wireless 4 scenes switches
1	5743 12	<p>Used to add 4 customised scenes to a connected installation</p> <p>Scenes can be customised in the Home + Control app</p> <p>Possibility to assign personalised names and to associate icons to the scenes in the Home + Control app</p> <p>Supplied with CR2032 3 V long-life battery for power supply</p> <p>Zigbee Certified Product</p> <p>Surface mounting version Arteur™ with Netatmo - 2 gang</p> <p>Supplied with integrated plastic cover, multi-standard support frame (with removable fins) and 2 removable stickers for fixing the control unit on any substrate</p> <p>To be equipped with 2 module surround plates (p. 34 to 35)</p> <p>LED function for low battery indication</p> <p> ○ White ● Magnesium ● Champagne ● Soft Alu</p> <p>Pocket remote control</p> <p> Can be attached to a keyring ● Magnesium</p>
1	5743 14	
1	5743 15	
1	5743 13	
1	0676 95	<p>Pocket remote control</p> <p> Can be attached to a keyring ● Magnesium</p>

Connected home

connected wireless curtain/blinds controls

Step 2: Connected products



5742 25



5742 74

Support frames and surround plates selection chart **p. 34 to 35**

Used to create a connected home. Requires prior installation of a Netatmo gateway module (p. 27)

Pack	Cat. Nos.	Wireless curtain/blind switches
1	5742 07	<p>Used for remote control or centralisation of up to 20 wired blind switches Pair by tapping the selected blind switch(es) or by using the Home + Control app Supplied with CR2032 3 V long-life battery for power supply LED function for low battery indication Zigbee Certified Product</p> <p>Surface mounting version - 1 gang Supplied with integrated plastic cover, multi-standard support frame (with removable fins) and 2 removable stickers for fixing the control unit on any substrate To be equipped with 2 module surround plates (p. 34 to 35)</p> <p>○ White ● Magnesium ● Champagne ● Soft Alu</p>
1	5742 25	
1	5742 34	
1	5742 16	
1	5742 74	<p>Flush mounting version - 1 module Supplied with integrated plastic cover and to be equipped with support frames (see opposite) and surround plates (p. 34 to 35) Can be installed in a flush mounting box in addition to wired products with recommended depth of 47 mm</p> <p>○ White ● Magnesium ● Champagne ● Soft Alu</p>
1	5742 95	
1	5743 29	
1	5742 99	
1	0648 71	<p>Accessory Pack of 3 x 4 extra removable stickers for fixing a wireless control</p>



Arteor™

international support frames and blank modules

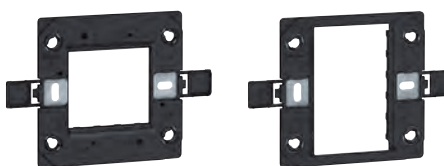

5760 03

5760 01



5760 00



5728 41



5700 60

Support frame and surround plate selection chart **p. 34 to 35**

Pack	Cat. Nos.	Support frames
		Screw mounting (screws supplied)
10	5760 03	<p>For 1 gang box Square - for 1 or 2 modules</p>
5	5760 01	<p>Square - for 3 modules</p>
10	5760 02	<p>For 2 gang box Rectangular - for 3 modules</p>
10	5760 00	<p>Rectangular - for 2 x 2 modules</p>
		Blank modules
10	5723 41	<p>1 module ○ White ● Magnesium ● Champagne ● Soft Alu</p>
10	5728 41	
10	5700 60	
10	5710 60	
10	5723 42	<p>2 modules ○ White ● Magnesium ● Champagne ● Soft Alu</p>
10	5728 42	
10	5700 61	
10	5710 61	

Arteor™ surround plate selection charts

60-3 mm fixing centres - flush mounting boxes, support frames and surround plates

Number of modules per mechanism	Flush mounting boxes ¹	Support frames	Plates	SURROUND PLATES											
				Neutral											
				White		Soft Alu		Graphite		Magnesium		Champagne		Dark Bronze	
				Pack:	Cat. Nos.	Pack:	Cat. Nos.	Pack:	Cat. Nos.	Pack:	Cat. Nos.	Pack:	Cat. Nos.	Pack:	Cat. Nos.
1 module	1 gang ²	5760 03		10	5752 00	10	5713 01	10	5752 02	10	5713 11	10	5713 21	10	5713 31
2 modules		5760 03 5760 01 ⁵		10	5752 10	10	5713 02	10	5752 12	10	5713 12	10	5713 22	10	5713 32
3 modules - 1 gang	1 gang ²	5760 01 ⁶		5	5751 60	5	5713 03	5	5751 62	5	5713 13	5	5713 23	5	5713 33
2 x 3 modules - 2 gang	2 gang ³	N/A ³		1	5712 10	1	5712 11	1	5712 12	1	5712 13	1	5712 14	1	5712 15
3 modules and shaver sockets	2 gang ⁴	5760 02		5	5750 70	5	5713 05	5	5750 72	5	5713 15	5	5713 25	5	5713 35
4 modules	2 gang ⁴	5760 00		5	5750 80	5	5713 04	5	5750 82	5	5713 14	5	5713 24	5	5713 34
6 modules	6890 27	Supplied with support frame		5	5753 70	5	5713 06	5	5753 72	5	5713 16	5	5713 26	5	5713 36
8 modules	6890 38	Supplied with support frame		5	5767 00	5	5713 08	5	5767 02	5	5713 18	5	5713 28	5	5713 38
2 x 6 modules	6890 28	Supplied with support frame		2	5753 90	2	5716 00	2	5753 92	2	5716 02	2	5716 04	2	5716 06
3 x 6 modules	0818 56	Supplied with support frame		2	5754 00	2	5716 01	2	5754 02	2	5716 03	2	5716 05	2	5716 07
Blanking cover plate	1 gang ²	5760 03 or 5760 01		5	5751 30	5	5716 08	5	5751 32	5	5716 10	5	5716 12	5	5716 14
Blanking cover plate	2 gang ⁴	5760 02		5	5751 40	5	5716 09	5	5751 42	5	5716 11	5	5716 13	5	5716 15

1 : For full details of flush mounting boxes, see Wiring Accessories guide p. 31

2 : Suitable for use with 1 gang back boxes. For Legrand options, see Wiring Accessories guide p. 31

3 : 2 x 3 modules - 2 gang surround plates are only for use with 2 gang connected socket outlets, see p. 29. Outlet supplied with support frame

4 : Suitable for use with 2 gang back boxes. For Legrand options, see Wiring Accessories guide p. 31

5 : Use Cat. No. 5760 01 support frame for 2 module mechanisms to be mounted on 3 module support frame, see p. 33

6 : Support frame not needed for use with connected socket outlets Cat. Nos. 574256, 574257, 574258, 574259 see p. 29

For the full range of wiring accessories, see **Wiring Accessories guide**



SURROUND PLATES

Mirror		Brushed Metal				Reflective			Wood	Signature
Mirror White	Mirror Black	Stainless Steel	Gold Brass	Pink Champagne	Black	Stainless Steel	Black	Gold	Grey Oak	Cube
Pack: Cat. Nos.	Pack: Cat. Nos.	Pack: Cat. Nos.	Pack: Cat. Nos.	Pack: Cat. Nos.	Pack: Cat. Nos.	Pack: Cat. Nos.	Pack: Cat. Nos.	Pack: Cat. Nos.	Pack: Cat. Nos.	Pack: Cat. Nos.
1 5752 04	1 5752 03	1 5752 06	1 5761 00	1 5713 51	1 5713 41	1 5713 61	1 5713 81	1 5713 71	1 5713 91	1 5714 01
1 5752 14	1 5752 13	1 5752 16	1 5761 20	1 5713 52	1 5713 42	1 5713 62	1 5713 82	1 5713 72	1 5713 92	1 5714 02
1 5751 64	1 5751 63	1 5751 66	1 5761 80	1 5713 53	1 5713 43	1 5713 63	1 5713 83	1 5713 73	1 5713 93	1 5714 03
1 5712 16	1 5712 17	1 5712 18	1 5712 19	1 5712 20	1 5712 21	1 5712 22	1 5712 23	1 5712 24	1 5712 25	1 5712 26
1 5750 74	1 5750 73	1 5750 76	1 5761 60	1 5713 55	1 5713 45	1 5713 65	1 5713 85	1 5713 75	1 5713 95	1 5714 05
1 5750 84	1 5750 83	1 5750 86	1 5761 40	1 5713 54	1 5713 44	1 5713 64	1 5713 84	1 5713 74	1 5713 94	1 5714 04
1 5753 74	1 5753 73	1 5753 76	1 5763 70	1 5713 56	1 5713 46	1 5713 66	1 5713 86	1 5713 76	1 5713 96	1 5714 06
1 5767 04	1 5767 03	1 5767 06	1 5767 10	1 5713 58	1 5713 48	1 5713 68	1 5713 88	1 5713 78	1 5713 98	1 5714 08
-	-	-	-	-	-	-	-	-	-	-
-	-	-	-	-	-	-	-	-	-	-
-	-	-	-	-	-	-	-	-	-	-
-	-	-	-	-	-	-	-	-	-	-