



MASTERSEAL PLUS™

IP66 Ingress Protected



Thrives in the Toughest Conditions.

ULTIMATE PROTECTION FOR THE GREAT BRITISH WEATHER

**MK ELECTRIC HAS ALWAYS BEEN
AT THE FOREFRONT OF
TECHNICAL INNOVATION, NOT
LEAST IN THE IP ENVIRONMENT.**

Masterseal Plus™ has been tested to levels well in excess of British Standards. Masterseal Plus™ safeguards users in the harshest of environments, employing a gel seal for improved protection.

With a superb rating of IP66, Masterseal Plus™ is dust-tight to any ingress, and water-tight against high-pressure water jets from any direction.

HOW TO SPECIFY

A range of water and dust tight enclosures, rated at IP66 when in use, manufactured from UV stable thermoplastic material and utilising a gel gasket seal and easy to open catch mechanism.

To enable quick and easy installation the seal will be fixed to the mounting frame of the unit.

Containing a urea moulded anti-bacterial range of wiring accessories, designed with soft curves and chamfered top edges that offer a slim unobtrusive appearance.

Cable connections must be upward facing with easy to identify white markings on a dark background, grouped in a straight line with captive terminal screws for ease of installation.

All standard BS sockets to have a 3 pin operated "child Resistant" shutter system and double pole switching, with the contacts designed such that the neutral makes before and breaks after the live pole for improved safety.

All products to be made in the UK.



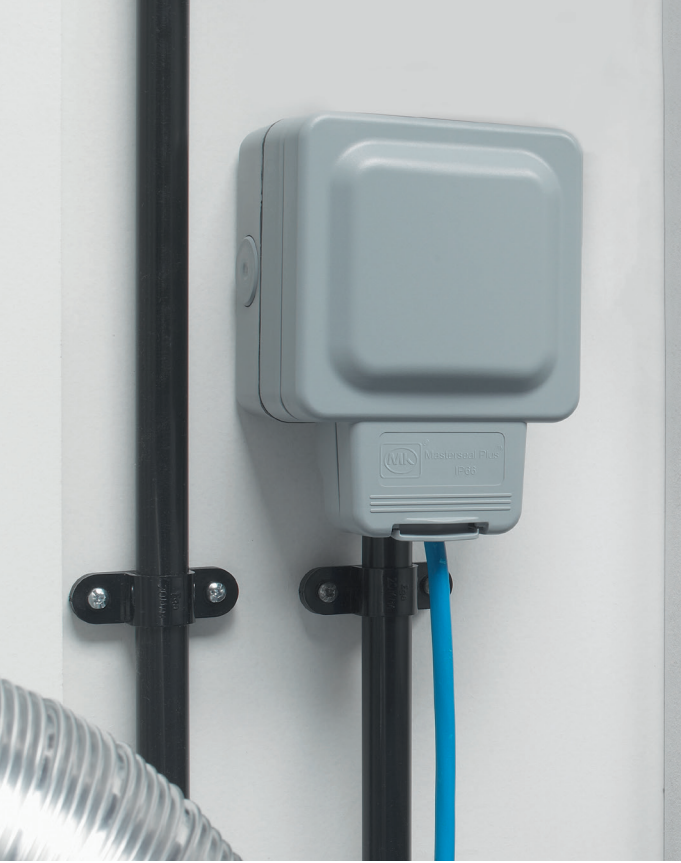

RANGE INTRODUCTION

MASTERSEAL PLUS HAS BEEN SPECIFICALLY DEVELOPED FOR USE IN BOTH OUTDOOR AND INDOOR ENVIRONMENTS, AND WHERE WIRING DEVICES AND ACCESSORIES WOULD BE AT RISK FROM PENETRATION BY DUST OR WATER.

With a rating of IP66*, Masterseal Plus™ offers total protection against dust, and is protected against high pressure jets of water from any direction. Masterseal Plus™ sockets can seal around virtually any standard 13A plug – including moulded plugs – allowing safe connection for any appliance.

An improved catch eases the opening and closing of the lid, whilst ensuring the integrity of the seal. The gasket is fixed to the mounting frame of the product, enabling rapid installation, and removing the risk of error when placing a floating gasket.

The Masterseal Plus™ range extends to over 90 product variations as the enclosures house selected products from the Logic Plus portfolio – thus offering all the benefits of the Logic Plus™ range within the Masterseal Plus™ enclosures.

FEATURES & BENEFITS

IP66*

Masterseal Plus™ offers total dust ingress protection, and is protected against high-pressure water jets from any direction, when in use.

Robust Construction and Temperature Tolerant

Masterseal Plus™ will not discolour, crack or fade in UV light (unlike many other plastics), and will maintain operation in extremes of heat and cold.

Impact Protection

Masterseal Plus™ enclosures are made from polycarbonate, one of the toughest thermoplastics available – incidentally also used in products such as motorcycle helmets.

Widest Range

The Masterseal Plus™ range extends to over 90 product variants. The enclosures house products from the Logic Plus™ range, all enclosures and switches are available in Grey, White and Black.

20 Year Guarantee

Masterseal Plus™ is guaranteed for 20 years. (10 years for electronic products)

*Grid Plus enclosures are IP56

MASTERSEAL PLUS INGRESS PROTECTED – IP66

MASTERSEAL PLUS IS PERFECTLY SUITED TO A RANGE OF INDOOR AND OUTDOOR ENVIRONMENTS.

Typical installations include factories, swimming pools, laboratories, commercial kitchens, industrial units, warehouses, and cleanrooms.

The wide portfolio of products extends to over 90 product variants providing a solution for every application, ensuring wiring devices and accessories are protected in the toughest conditions.



SOLID PROTECTION

Dust Tight:

No ingress of dust.
Complete protection against contact.

LIQUID PROTECTION

Powerful water jets:

Water projected in powerful jets against the enclosure from any direction shall have no harmful effects.

*Grid Plus enclosures are IP56



IP SOLUTIONS

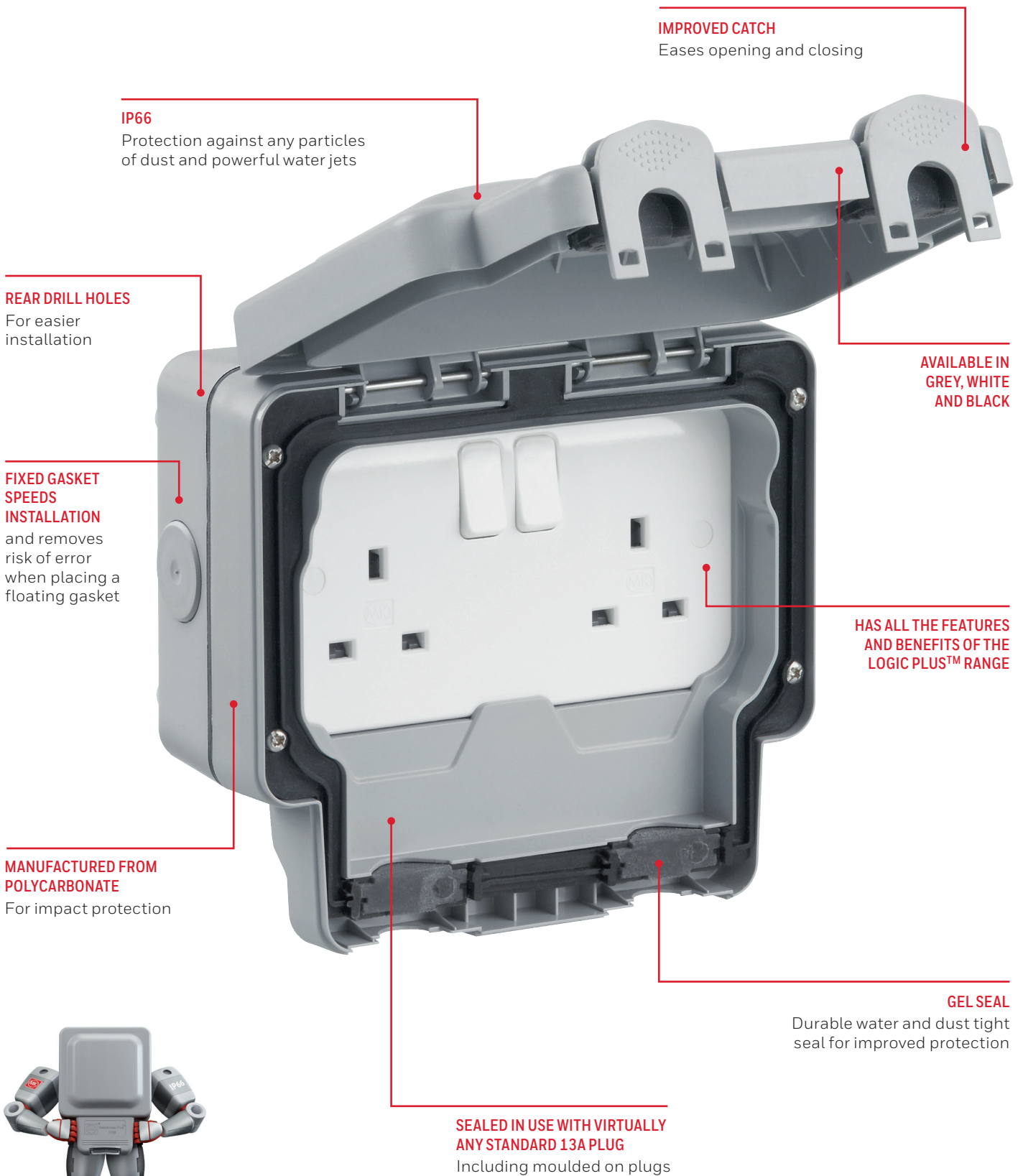

SOCKET OUTLETS

16 AMP
IP66 (NON UK)



K56483GRY



K56483WHI



K56483BLK

RCD protected sockets are pulsating d.c. and a.c. fault current sensitive.
Fixing holes are for No.8 woodscrews (not supplied).
Supplied with an earth terminal in the back box. The Sentrysocket has 5 entries. Suitable for supply voltage of 240V a.c. 50Hz
Standard Shutters.

DIMENSIONS
157 x 175 x 89mm
BS 7288:1990
IP66 BS EN 60529:1992

Masterseal enclosures are manufactured from polycarbonate. This provides an extremely high level of impact resistance. However some chemicals and synthetic oils can harm polycarbonate.

Refer to Technical Hotline for assistance

+44 (0) 1268 563720

Ingress Protection







MASTERSEAL PLUS PRODUCT SELECTOR

KEY OPERATED SWITCHES	CONNECTION UNITS	SWITCHES			GRID PLUS ENCLOSURES
20 AMP IP66	13 AMP IP66	10 AMP IP66	10 AMP IP66	20 AMP IP66	IP56
					
K56425GRY	K56410WHI	K56400GRY	K56406GRY	K56409GRY	K56414GRY
					
K56425WHI	K56410BLK	K56401WHI	K56407BLK	K56409WHI	K56414WHI
					
K56425BLK	K56410GRY	K56402BLK	K56408WHI	K56409BLK	K56414BLK
K56425GRY K56425WHI K56425BLK 20A 1 GANG DP KEY OPERATED SWITCH Fixing holes are for No.8 woodscrews (not supplied). K56425 Backbox has 4 x 20mm entries, 1 on top, bottom and each side and is supplied with an earth terminal in the back box. DIMENSIONS 160 x 117 x 89mm BS EN 60669-1:1999 IP66 BS EN 60529:1992	K56410GRY K56410WHI K56410BLK 13A DP 1 GANG SWITCHED, FUSED Fitted with a 13A fuse link to BS 1362. Fixing holes are for No.8 woodscrews (not supplied). Backbox has 4 x 20mm entries, 1 on each edge, and is supplied with an earth terminal in the backbox. DIMENSIONS 160 x 117 x 89mm BS 1363-4:1995 IP66 BS EN 60529:1992	K56400GRY K56400WHI K56400BLK 10A 1 GANG SP ONE-WAY K56401GRY K56401WHI K56401BLK 10A 1 GANG SP TWO-WAY K56402GRY K56402WHI K56402BLK 10A 2 GANG SP ONE-WAY	K56406GRY K56406WHI K56406BLK 10A 1 GANG DP ONE-WAY K56407GRY K56407WHI K56407BLK 10A 1 GANG SP TWO-WAY PUSH TO MAKE OR PUSH TO BREAK 'BELL' K56408GRY K56408WHI K56408BLK 10A 1 GANG SP TWO-WAY PUSH TO MAKE OR PUSH TO BREAK 'PRESS'	K56409GRY K56409WHI K56409BLK 20A 1 GANG DP ONE-WAY 'PRESS' Fixing holes are for No.8 woodscrews (not supplied). Each switch is fitted with a neon which can be wired as a locator. The enclosure has 4 x 20mm entries, 1 on top, bottom and each side and is supplied with an earth terminal and a loop terminal in the back box. DIMENSIONS 95 x 95 x 57mm BS EN 60669-1:1999 IP66 to BS EN 60529:1992	K56414GRY K56414WHI K56414BLK MODULAR GRID PLUS ENCLOSURE SUPPLIED WITH 1 AND 2 GANG INSERTS* Fixing holes are for No.8 woodscrews (not supplied). Backbox has 4 x 20mm entries, 1 on top, bottom and each side. Supplied with an earth terminal and a loop terminal in the backbox. DIMENSIONS 95 x 95 x 80mm BS EN 60669-1:1999 IP56 to BS EN 60529:1992

Fixing holes are for No.8 woodscrews (not supplied).
 Each switch is fitted with a neon which can be wired as a locator.
 The enclosure has 4 x 20mm entries, 1 on top, bottom and each side and is supplied with an earth terminal and a loop terminal in the back box.
 These switches (except push switches) do NOT have to be derated when used with fluorescent or inductive loads.
 DIMENSIONS
 95 x 95 x 57mm
 BS EN 60669-1:1999
 IP66 to BS EN 60529:1992

* NOTE: Installers may select any switch or neon modules, excluding dimmers, from Grid Plus range and configure product to suit installation requirements.

Ingress Protection
MASTERSEAL PLUS PRODUCT SELECTOR

SWITCH ENCLOSURES	SWITCH MODULES		NEON MODULES	DATA/TELECOM ENCLOSURES EURO FORMAT	EURO DATA MODULES	
IP66	10 AMP	20 AMP		IP66	TELECOM	
						
K56420GRY	56881BLK	56891BLK	56889RED	K56423GRY	K5820WHI	K5820BLK
						
K56421WHI	56882BLK	56892BLK	56893BLK	K56423WHI	K5821WHI	K5821BLK
						
K56422BLK	56883BLK	56896BLK		K56423BLK		
						
K56422GRY						

K56420GRY	1	56881BLK	10	56891BLK	10	56889RED	10	K56423GRY	1	K5820WHI	5
K56420WHI	1	10A SP		20A SP		200-250V NEON		K56423WHI	1	K5820BLK	5
K56420BLK	1	ONE-WAY		ONE-WAY		RED		K56423BLK	1	TELEPHONE MASTER	
1 GANG FOR USE WITH ANY		56882BLK	10	56892BLK	10	BS 5733: 2010		1 GANG		ONE MODULE	
ONE SWITCH MODULE		10A SP		20A SP				DATA ENCLOSURE		K5821WHI	5
K56421GRY	1	TWO-WAY		TWO-WAY				FOR 2 MODULE EURO		TELEPHONE SECONDARY	5
K56421WHI	1	56883BLK	10	56893BLK	10			OUTLET		ONE MODULE	
K56421BLK	1	10A DP		20A				2 data modules can be			
1 GANG WITH NEON FOR USE		ONE-WAY		INTERMEDIATE				accommodated providing care is			
WITH ANY SWITCH AND ANY				56896BLK	10			used to ensure that the cables are			
NEON MODULE				20A DP				correctly routed through the outlet.			
K56422GRY	1	For use only with		ONE-WAY				Fixing holes are for No.8			
K56422WHI	1	Masterseal Plus™ switch enclosures.						woodscrews (not supplied).			
K56422BLK	1	These switches do NOT have to be						Backbox has 4 x 20mm entries,			
2 GANG FOR USE		derated when used with fluorescent						1 on each edge. Supplied with an			
WITH ANY TWO SWITCH		or inductive loads.						earth terminal and a loop terminal			
MODULES		BS EN 60669-1:1999						in the backbox.			
								DIMENSIONS			
								160 x 117 x 89mm			
								IP66 to BS EN 60529:1992			

Fixing holes are for No.8 woodscrews (not supplied).

Each enclosure is fitted with a neon which should be wired as a locator. The enclosure has 4 x 20mm entries, 1 on top, bottom and each side and is supplied with an earth terminal and a loop terminal in the back box.

NOTE
These enclosures are for use with the Masterseal Plus™ switch and neon modules.

DIMENSIONS
95 x 95 x 57mm
IP66 to BS EN 60529:1992

For the full range
of euro modules
see the MK Catalogue

EURO DATA MODULES	JUNCTION BOXES	FLUSH MOUNTING FRAMES	FLUSH MOUNTING BEZELS	CONDUIT ENTRIES	ACCESSORIES
<p>DATA</p>  <p>5844WHI</p>  <p>K5887WHI</p>  <p>K5887BLK</p>	<p>30 AMP IP66</p>  <p>K56506GRY</p>  <p>K56506WHI (COVER ON)</p>  <p>K56506WHI (COVER ON)</p>	 <p>K56500GRY</p>  <p>56500WHI</p>  <p>K56501GRY</p>	 <p>K56502GRY</p>  <p>56502WHI</p>  <p>K56503GRY</p>	 <p>56460WHI</p>  <p>56461WHI</p>  <p>56462WHI</p>  <p>56463WHI</p>  <p>56464WHI</p>	 <p>MK9933</p>  <p>56890GRN</p>
<p>K5844WHI RJ45 CAT 5e ANGLED UNSCREENED ONE MODULE</p> <p>K5887WHI K5887BLK RJ11/12 ONE MODULE</p> <p>K5844 Enhanced Cat 5e performance. Suitable for both 568A and 568B wiring schemes.</p> <p>ISO/IEC 11801 EN 50173 TIA 568 EN 41003</p> <p>K5887 Suitable for both RJ11 and RJ12 jacks RJ11 4 wire RJ12 6 wire</p> <p>FCC68 EN 41003</p> <p>DIMENSIONS 25 x 50mm</p>	<p>5</p> <p>K56506GRY K56506WHI K56506BLK JUNCTION BOX WITH FOUR 4-WAY TERMINALS</p> <p>Fixing holes are for No. 8 woodscrews (not supplied). The enclosure has 4 entries, 1 on top, bottom and both sides.</p> <p>TERMINAL CAPACITY Each terminal block accepts four 2.5mm² cables.</p> <p>DIMENSIONS 95 x 95 x 65mm BS 6220:1983 IP66 to BS EN 60529</p>	<p>1</p> <p>K56500GRY K56500WHI 1 GANG PLASTER/TILE FLUSH MOUNTING FRAME WITH PROTECTIVE COVER FOR USE WITH 160 X 117MM PRODUCTS</p> <p>1</p> <p>56500GRY 56500WHI 1 GANG PLASTER/TILE FLUSH MOUNTING FRAME WITH PROTECTIVE COVER FOR USE WITH 95 X 95MM SWITCHES</p> <p>1</p> <p>K56501GRY K56501WHI 2 GANG PLASTER/TILE FLUSH MOUNTING FRAME WITH PROTECTIVE COVER</p> <p>The Flush adaptors for plaster and tile can be used with finish depths up to 20mm, by using the spacers provided. Allows flush mounted Masterseal Plus™ products to maintain their IP rating. Can be used with side entry or back entry enclosures.</p> <p>DIMENSIONS 56500 115 x 115 x 34mm K56500 135 x 135 x 34mm K56501 135 x 195 x 34mm</p>	<p>1</p> <p>K56502GRY K56502WHI 1 GANG FLUSH MOUNTING BEZEL FOR USE WITH 160 X 117MM PRODUCTS</p> <p>1</p> <p>56502GRY 56502WHI 1 GANG FLUSH MOUNTING BEZEL FOR USE WITH 95 X 95MM SWITCHES</p> <p>1</p> <p>K56503GRY K56503WHI 2 GANG FLUSH MOUNTING BEZEL</p> <p>The Flush adaptors for brick and cavity walls should be used on vertical surfaces where no additional finishing, such as plastering is required. Allows flush mounted Masterseal Plus™ products to maintain their IP rating. Can only be used with back entry enclosures. Supplied with 4 self tapping screws to fix enclosure to mounting bezel. Clip-on surround hides mounting screws.</p> <p>DIMENSIONS 56502 145 x 145 x 41mm K56502 165 x 165 x 41mm K56503 165 x 245 x 41mm</p>	<p>5</p> <p>56460GRY 56460WHI ENTRY BLANK</p> <p>5</p> <p>56461BLK 56461WHI PVC CABLE ENTRY TO PROVIDE DIRECT ENTRY OF POWER CABLE TO THE UNIT VIA THE BOTTOM BOX ENTRY</p> <p>5</p> <p>56462BLK 56462WHI 20MM PLAIN CONDUIT ENTRY PUSH FIT ADAPTOR BETWEEN BACK BOX AND 20MM PLAIN CONDUIT</p> <p>5</p> <p>56463BLK 56463WHI 20MM THREADED CONDUIT ENTRY PUSH FIT ADAPTOR BETWEEN BACK BOX AND 20MM THREADED CONDUIT</p> <p>5</p> <p>56464BLK 56464WHI BOX COUPLER FOR GANGING ONE MASTERSEAL PLUS™ BOX NEXT TO ANOTHER</p>	<p>1</p> <p>MK9933 M20 EARTH LEAD ADAPTOR FOR EARTHING METAL CONDUIT</p> <p>5</p> <p>56890GRN REPLACEMENT NEON LOCATOR</p>

Ingress Protection

MASTERSEAL PLUS PRODUCT SELECTOR

ECHO™ IS AN INNOVATIVE RANGE OF ENTIRELY WIRELESS, BATTERYLESS AND SELF-POWERED SWITCHES

1 AND 2 CHANNEL TRANSMITTER FOR ECHO™	ENCLOSURE
---------------------------------------	-----------



WIRELESS

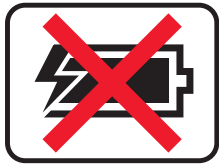

BATTERYLESS



SELF-POWERED

IP66



K55400GRY

IP66



K55000GRY



K55406WHI



K55406BLK

WIRELESS

No wires offers the benefits of almost instant switch installation and total location flexibility, resulting in reduced costs and disruption as well as improved speed and ease of installation – invaluable for areas needing to rearrange space periodically, e.g. commercial offices, or those where the channelling of walls isn't permissible or feasible, such as historic buildings or glass partition walls.

BATTERYLESS

No batteries means low maintenance and low running costs. No need to buy, fit, replace or dispose of batteries, eliminating nuisance and waste for a more sustainable option.

SELF-POWERED

The new Echo™ range works by harvesting tiny amounts of ambient energy which power a switch (Transmitter) to send an RF signal to the Switch Receiver which is connected to the lighting circuit – operating lighting at ranges of up to 30 metres within typical buildings.

K55400GRY	1	K55000GRY	1
K55400WHI	1	K55000WHI	1
K55400BLK	1	K55000BLK	1
1 CHANNEL TRANSMITTER FOR ECHO™			
K55406GRY	1		
K55406WHI	1		
K55406BLK	1		
2 CHANNEL TRANSMITTER FOR ECHO™			

No wires

- Instant switch installation
- Location/relocation flexibility
- Simplifies office 'churn' – less disruption

No batteries

- Low maintenance
- Low running costs
- Less waste, a more sustainable option
- No nuisance factor

Flexibility

- No wires, no constraints
- Suitable for all wall types, including where channelling isn't feasible
- Ideal for commercial, residential and historic buildings

Quality reliability and safety come as standard
10 year guarantee





MK Electric

UK

The Arnold Centre, Paycocke Road, Basildon,
Essex, SS14 3EA, United Kingdom

Customer Service Tel +44 (0)1268 563404

Customer Service Fax +44 (0)1268 563405

E-mail mkordenenquiries@honeywell.com

Technical

Tech Helpline Tel +44 (0)1268 563720

Tech E-mail mk.technical@honeywell.com

Ireland

Sales Telephone +353 1 429 6530

Sales Fax +353 1 429 6501

E-mail mkirelandorders@honeywell.com

www.mkelectric.co.uk



Download the MK
Catalogue app

Reference UKMK408-0718-EN
July 2018
© 2018 Honeywell International Inc.

