

Gateway module

Cat. number : 4 121 81 / 4 121 91



Sommaire	Pages
1. Description - Use.....	1
2. Range.....	1
3. Overall dimensions.....	1
4. Preparation - Connection.....	1
5. General characteristics.....	3
6. Compliance and approvals.....	4
7. Auxiliaries and accessories.....	4

1. DESCRIPTION - USE

Use:

In a Home+ Control installation, allows to create a wireless network of connected devices and operate as a gateway with the IP network through the Wifi.

Technology:

- . Modular gateway Wifi ↔ RF between the IP network and the connected devices network " ... with Netatmo ".
- . To be installed in the electrical panel board.

2. RANGE

Width:

- . 2,5 modules. 45 mm wide.

Power consumption:

- . 2W Maxi

Rated voltage:

- . 100 to 240V AC

Rated frequency:

- . 50Hz / 60Hz

Configuration and use:

- Legrand smartphone app " HOME + CONTROL "



- . Available for free on Google Play or App Store
- Voice assistants (compatible with the main voice assistants of the market).



Apple Home Kit:

Apple Home Kit technology compatible to remote controlling the connected home. It allows you to control devices by voice, for example, using Siri voice assistant from your iPhone, iPad, Home Pod or Apple Watch.

3. OVERALL DIMENSIONS

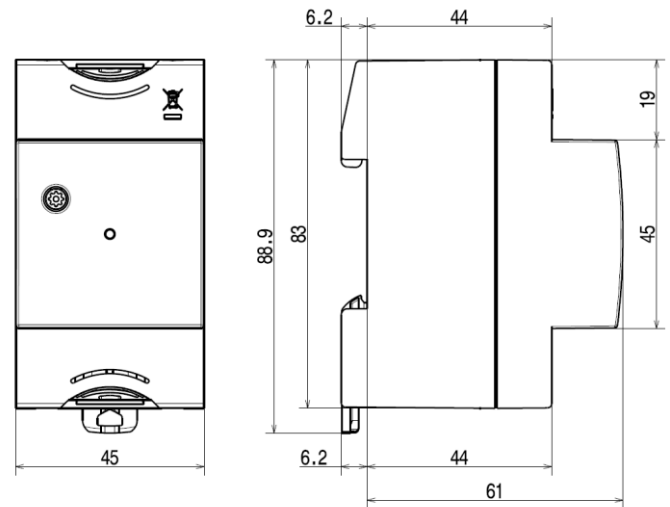

4. PREPARATION - CONNECTION

Mounting:

- . On symmetrical rail EN / IEC 60715 or DIN 35.

Operating position:

- . Vertical, Horizontal, Flat.



4. PREPARATION - CONNECTION *(continued)*

Row positioning:

. The product shape and the positioning of the terminals allow the passage of single-line, three-lines and plug-in supply busbars in the upper part of the product. Then, it is possible to freely choose the position of the Gateway module in the row and to connect by supply busbar the other devices put on the same DIN rail.

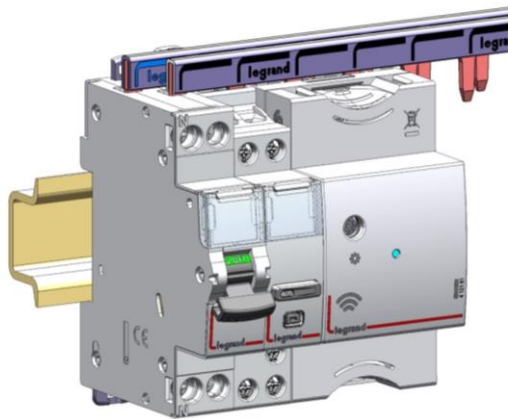

Wiring of the power supply :

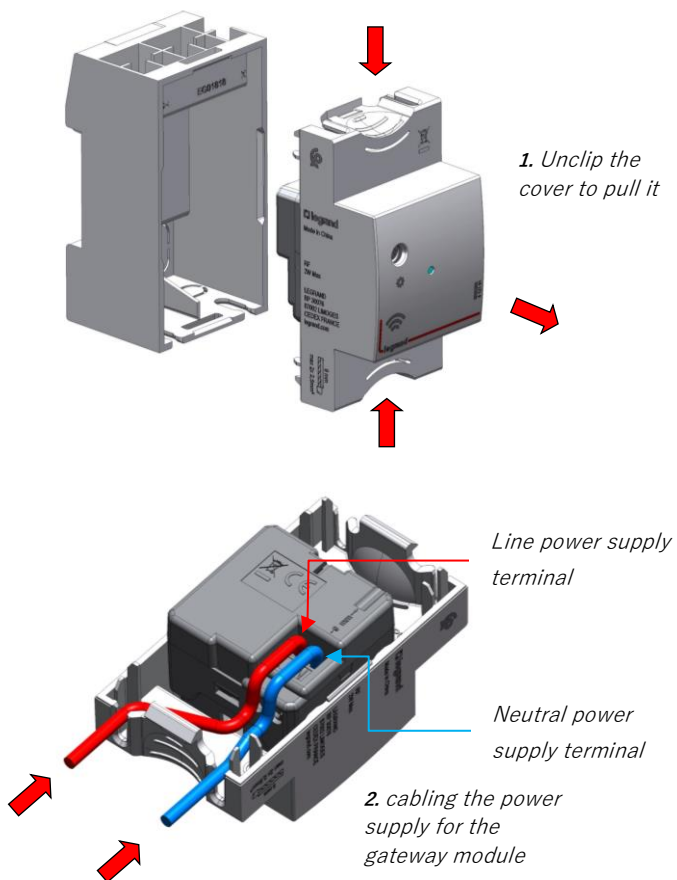

4. PREPARATION - CONNECTION *(continued)*

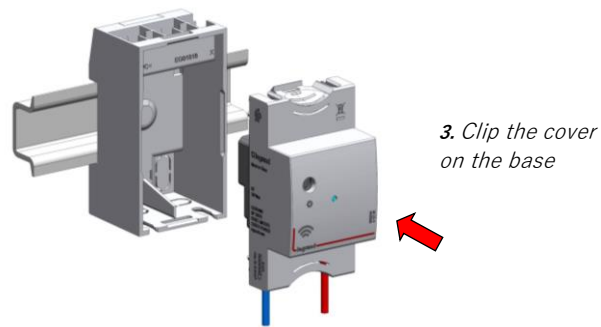

Cable the gateway module after a circuit breaker

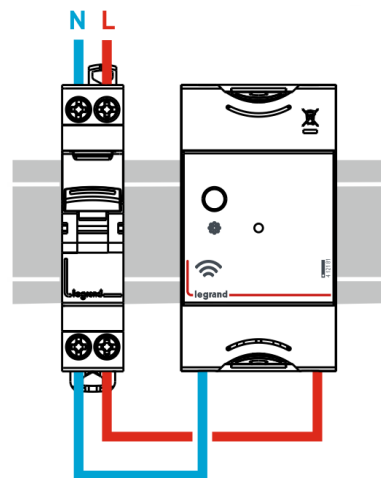

Recommended tools:

- . For the terminals: screwdriver flat-blade 3.5 mm
- . For clamping: screwdriver flat-blade (5,5 mm or less).

Connection:

- . Screw terminals:
 - Terminal type: cage
 - Depth: 9 mm
 - Stripping length recommended: 9 mm
 - Screw head: slotted 3.5 mm
 - Type of screw: M3,5
 - Tightening torque: 0.5 Nm

Conductor type:

- . Copper cables

	Without ferrule	With ferrule
Rigid cable	1x (1 to 2.5mm ²) 2 x (1 to 2.5mm ²)	-
Flexible cable	1x (1 to 2.5mm ²) 2 x (1 to 2.5mm ²)	1 x (1 to 2.5mm ²)

4. PREPARATION - CONNECTION *(continued)*

Visualization of the operating mode of the device:

. Via LED on the front face of the product.

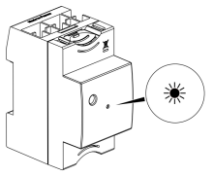

Color	Status	Meaning
	OFF	Normal operating mode
	Fixed	Transient state. Beginning phase
	Fixed	Transient state. Open Network to Pair Connected devices
	Fixed	Transient state. Initialization phase of the configuration (factory reset)

Installation of a Module (several steps):

. 1/ Beforehand, to create a connected installation you must install:

A gateway module

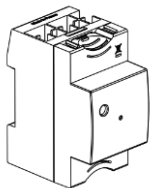

Connected devices (see chapter 7 Auxiliaries and accessories)

. 2/ Beforehand, the general circuit breaker must be turned OFF, and only after wiring step done, can be powered back ON to simultaneously power devices and allow them to be connected to the network.

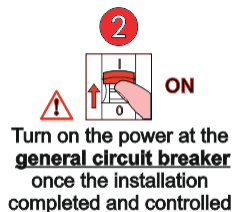
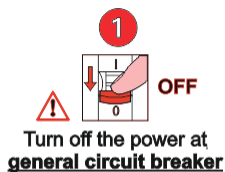

4. PREPARATION - CONNECTION *(continued)*

Installation of a Module (several steps) *(continued)*:

. 3/ Press and hold the gateway module settings button for more than 3 seconds until the LED turns green, then release the button.

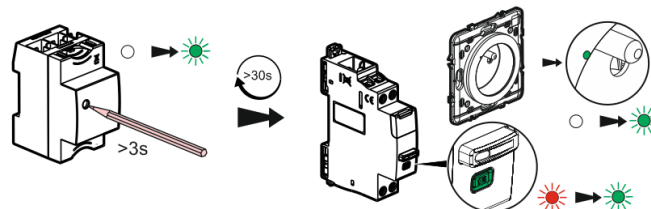

. The configuration LEDs of " ... with Netatmo " devices in the installation must all light up in fixed green.

. 4/ To complete the installation, briefly press the setting button on the Gateway module to finalize the installation.

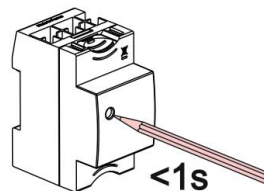

All " ... with Netatmo " devices LED go OFF

Connected system:

. Maximum radio devices connected to a gateway module: 100

Gateway module resetting:

. Press and hold over 5 seconds on the setting button until the LED on the front face be fixed red.

Other configurations & actions

. All other features and settings such as ; scenarios etc... are directly explained step by step in the smartphone app.

5. GENERAL CHARACTERISTICS

Marking of the Gateway module:

Markings of the front side:

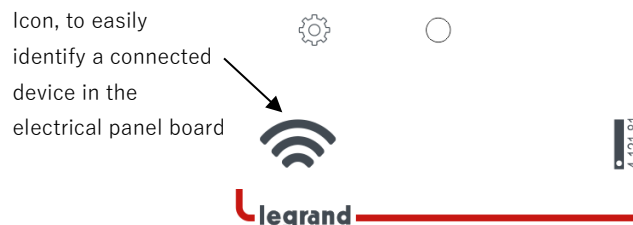

5. GENERAL CHARACTERISTICS (continued)

Lateral marking



legrand

Made in China

RF
2W Max

LEGRAND
BP 30076
87002 LIMOGES
CEDEX FRANCE
legrand.com



Influence of altitude: Characteristics of the radio interface:

- . Standard IEEE 802.15.4
- . Frequencies 2,4 à 2,4835Ghz
- . Transmitter output power <100mW
- . No influence up to 2 000 m

Assigned frequency:

- . 50 / 60Hz

Rated voltage of use (Ue):

- . Ue = 100 à 240 V ~

Recommendations:

- . For the device protection against short circuits, it is recommended to use a circuit breaker or fuse gG rated current ≤ 16 A.

Characteristics of the radio interface:

- . Standard IEEE 802.11
- . Standard IEEE 802.15.4
- . Frequencies 2,4 à 2,4835Ghz
- . Transmitter output power <100mW
- . Distance max between 2 radio devices: 50m in open field

Protection degree:

- . Protection index of terminals against direct contacts: IP2X (IEC/EN 60529)
- . Protection index of the front face against direct contacts: IP3XD (IEC/EN 60529)
- . Class II, front panel with faceplate.

Plastic material:

- . Self-extinguishing polycarbonate.

Ambient operating temperature:

- . Min. = - 5 ° C Max. = + 45 ° C.

Ambient storage temperature:

- . Min. = - 40 ° C Max. = + 70 ° C.

5. GENERAL CHARACTERISTICS (continued)

Average weight:

- . Poids. = 86g

Volume when packed:

- . 0,62 dm³.

Environmental profile:

- . PEP document available

Installation software:

- . XL PRO3

6. COMPLIANCE AND APPROVALS

Compliance to standards:

- EN 301 489-1

Environment respect – Compliance with European Union Directives:

- . Compliance with Directive 2002/95/EC of 27/01/03 known as "RoHS" which provides for a restriction on the use of dangerous substances such as lead, mercury, cadmium, hexavalent chromium and polybrominated biphenyl (PBB) and polybrominated diphenyl ether (PBDE) brominated flame retardants from 1st July 2006
- . Compliance with the Directive 91/338/EEC of 18/06/91 and decree 94-647 of 27/07/04
- . Compliant with regulation REACH

Conformity with electromagnetic interference (EMC):

- . Compliant EN 301 489-1:
- Immunity to electrical transients in bursts.
- Immunity to shock waves (2KV)

Plastic materials:

- . Halogen-free plastics.
- . Marking of parts according to ISO 11469 and ISO 1043.
- . ISO 7000: 2004, Graphical symbols to be used on equipment - Index and synopsis

Packaging:

- . Design and manufacture of packaging in accordance with Decree 98-638 of 20/07/98 and Directive 94/62 / EC.

7. AUXILIARIES AND ACCESSORIES

