

Synergy™
Socket outlets BS 13 A
Metalclad

Cat. No(s): 7 338 65/75

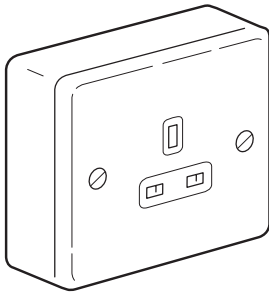

7 338 65

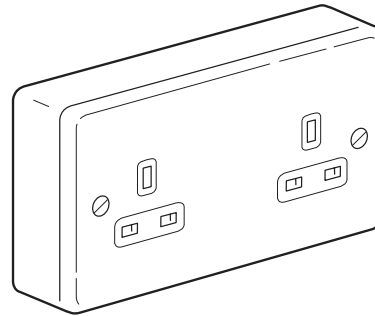

7 338 75

1. USE

British standard socket outlet, delivered complete for surface-mounting. Fixing with screws.

2. RANGE

Socket outlet - 1-Gang unswitched	7 338 65
Socket outlet - 2-Gang unswitched	7 338 75

3. OVERALL DIMENSIONS (mm)

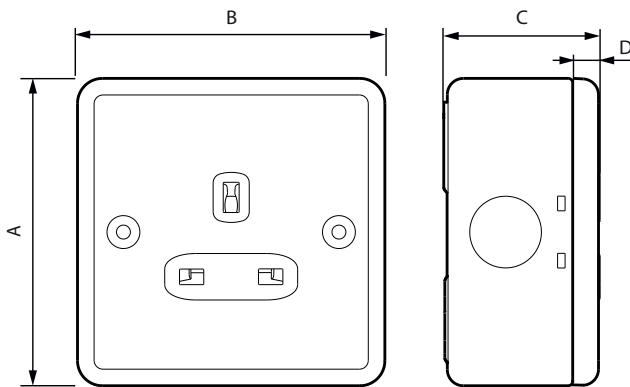

Cat. Nos	A	B	C	D
7 338 65	86	86	43	7
7 338 75	86	146	43	7

4. CONNECTION

Type of terminals: with screws
 Terminal capacity: 3 x 2.5 mm² - 2 x 4 mm² - 2 x 6 mm²
 Stripping length: 12 mm
 Compatible with flexible or rigid cables

5. TECHNICAL CHARACTERISTICS

■ **5.1 Mechanical characteristics**

Impact tests: IK 08
 Penetration by solid bodies/liquids: IP 20

■ **5.2 Material characteristics**

Front cover: PC - Color: White
 Front plate and surface mounting back box: Grey epoxy coated steel
 Mechanism housing: PP - Color: Grey

Halogen free
 UV resistant

Self-extinguishing:

- + 850° C / 30 s for insulating parts holding live parts in place.
- + 650° C / 30 s for other parts made of insulating materials.

■ **5.3 Electrical characteristics**

Voltage: 250 V~
 Current: 13 A
 Frequency: 50/60 Hz

■ **5.4 Climatic characteristics**

Storage temperature: - 10° C to + 70° C
 Use temperature: - 5° C to + 35° C

6. CLEANING

Clean the surface with a cloth or soapy water.
 Do not use acetone, tar-removing cleaning agents or trichloroethylene.

Caution: An initial test is required for the use of other special maintenance products.

7. STANDARDS AND APPROVALS

Compliance with standards of installation and manufacturing.
 See e.catalogue.