

	6 037 70	6 037 71
	230V 50/60Hz	230V 50/60Hz
	1x 16A/250V~μ cos φ = 1	2x 16A/250V~μ cos φ = 1
Power consumption	0,9 W	1,3 W
Programs:	28	14 / channel
Ganggenauigkeit	± 1 s / day under typical installation conditions	
	1 ... 4 mm <sup>2</sup>	0,5 ... 2,5 mm <sup>2</sup>
Battery reserve:	3 years	
	- 20 °C ... +55 °C	
	- 20 °C ... +60 °C	

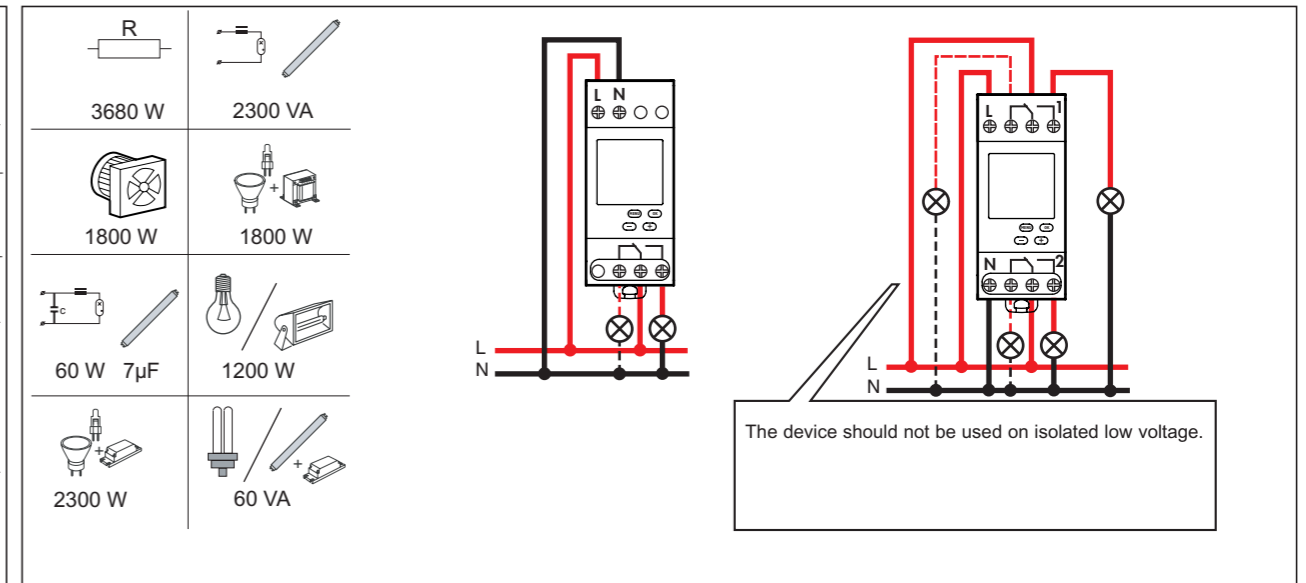

**⚠ Safety notes**

This product may be installed only by a qualified electrician. Non-compliance may result in a fire hazard or electric shocks. Before installation, read the operating instructions and observe the product-specific requirements for the installation location. Use only original spare parts for repair and maintenance. All Legrand products may be opened and repaired only by specially trained Legrand personnel. Unauthorised opening and repair by other persons will invalidate all claims for liability, replacement or warranty services. The device contains a Li cell type battery (Li) CR2032. When the product reaches the end of its life, this cell must be correctly removed and disposed of in accordance with national legislation and the requirements of environmental protection.

Operating principle:  
Typ 1.B. S. T.  
IEC/EN 60730-1,  
IEC/EN 60730-2-7  
Operation in a normal environment  
Montage: in distribution panel,  
Degree of contamination: 2  
Switch output, potential-free

